

Megapixel IP Camera

network DynaHawk™
060 Series

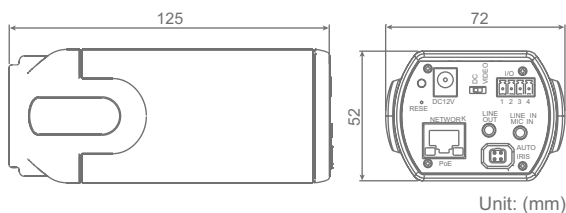

Dimension



Features

- Sony Progressive scan CCD/CMOS sensor
- Dual streaming: MPEG-4 & MJPEG
- Day/Night function (ICR); *optional*
- Power over Ethernet (802.3af); *optional*
- Varifocal lens f= 3.3 ~ 12 mm; *optional*
- WDR (Wide Dynamic Range); *optional*
- NEW** • Tampering Alarm
- Motion Detection
- NEW** • Privacy Masks
- 12× Digital Zoom
- Backlight Compensation / Auto Exposure / Flickerless mode
- Digital slow shutter
- Two-way audio support
- Built-in microphone; *optional*
- Free bundled CMS software

network DynaHawk™
070 Series



Dimension

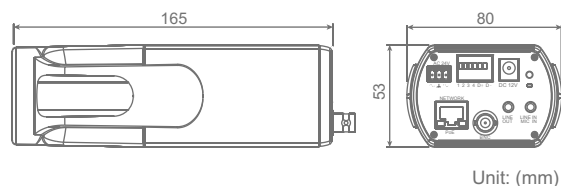

Features

- Sony 1.3 Megapixel Progressive scan CCD sensor
- Dual streaming: MPEG-4 & MJPEG
- Day/Night function (ICR)
- Power over Ethernet (802.3af)
- NEW** • Auto focus lens f= 4.95 ~ 49.5 mm
- NEW** • Motion Detection
- 10× Optical Zoom with AF
- 12× Digital Zoom
- Low light sensitivity 0.001 lux @ F1.6
- Backlight Compensation / Auto Exposure / Flickerless mode
- Digital slow shutter
- Two-way audio support
- Half duplex RS-485; *optional*
- BNC analog output; *optional*
- Free bundled CMS software

network DynaHawk™ 101 Series



Dimension

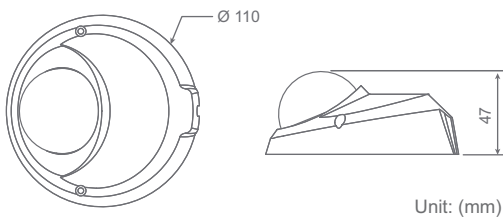

Features

- Sony 1.3 Megapixel Progressive scan CMOS sensor
- Dual streaming: MPEG-4 & MJPEG
- Power over Ethernet (802.3af)
- Fixed focal lens f= 4.3 mm
- NEW** • Tampering Alarm
- Motion Detection
- NEW** • Privacy Masks
- 12× Digital Zoom
- Backlight Compensation / Auto Exposure / Flickerless mode
- Digital slow shutter
- One-way audio support
- Built-in microphone; *optional*
- Weatherproof Dongle Cable; *optional*
- Weatherproof (IP66 international standard)
- Security Torx against tampering
- Free bundled CMS software

network DynaHawk™ 210 Series



Dimension

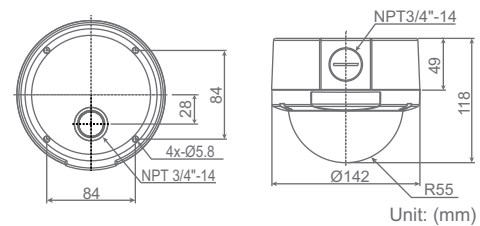

Features

- Sony Progressive scan CCD/CMOS sensor
- Dual streaming: MPEG-4 & MJPEG
- Day/Night function (ICR); *optional*
- Power over Ethernet (802.3af)
- Varifocal lens f= 3.3 ~ 12 mm
- NEW** • Tampering Alarm
- Motion Detection
- NEW** • Privacy Masks
- 12× Digital Zoom
- Backlight Compensation / Auto Exposure / Flickerless mode
- Digital slow shutter
- Two-way audio support
- Weatherproof (IP66 international standard)
- Security Torx against tampering
- 3-axis (pan/tilt/rotation) position adjustment
- Built-in heater and fan; *optional*
- 4S mount support
- Free bundled CMS software

Megapixel IP Camera

Value Chart

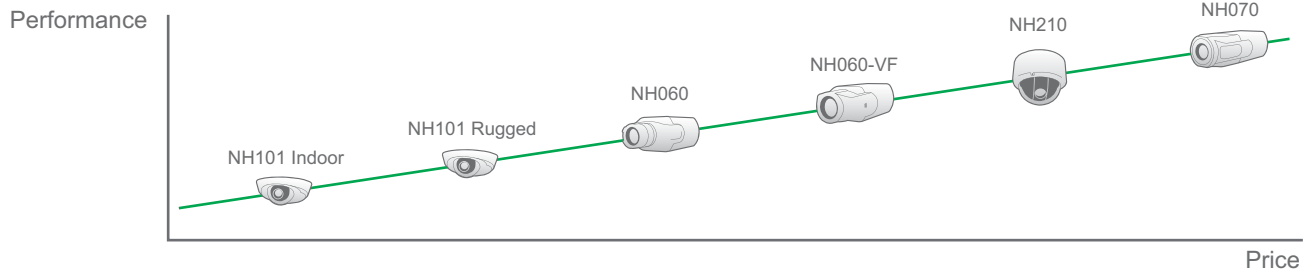

Comparison Chart

Item	NH101 Indoor	NH101 Rugged	NH060	NH060-VF	NH210	NH070
CCD	-	-	•	•	•	•
CMOS	•	•	•	•	•	-
Lens	fixed focal	fixed focal	C/CS mount	varifocal	varifocal	10× AF
ICR	-	-	○	○	○	•
Audio in	-	-	•	•	•	•
Audio out	-	-	•	•	•	•
Mic in	○	-	○	○	-	-
BNC	-	-	-	-	-	○
SD card	-	-	-	-	-	○
RS-485	-	-	-	-	-	•
Vandal proof	-	-	-	-	•	-
IP66	-	•	-	-	•	-

• Supported ○ Optional - Not supported

Specification

Item	CCD Cameras	CMOS Cameras
Camera		
Image Sensor	Sony 1/3" Progressive CCD	Sony 1/3.8" Progressive CMOS
Picture Elements	1280 (H) × 960 (V)	1280 (H) × 960 (V)
Resolution	>700 TVL	>700 TVL
Minimum Illumination	0.02 lux @ F 1.2 (Color) 0.001 lux @ F1.2 (B/W)	0.06 lux @ F 1.2 (Color) 0.005 lux @ F1.2 (B/W)
Shutter Speed	1.5 ~ 1/10000 sec.	1.5 ~ 1/15000 sec.
White Balance	Manual / ATW (1500 ~ 15000 K)	
Digital Zoom	1× ~ 12×	
Operation		
Video Compression	MPEG-4 / MJPEG	
Video Streaming	Simultaneous MPEG-4 and MJPEG video stream (Dual stream)	
Resolution	MPEG-4: VGA, QVGA, CIF, QCIF MJPEG: 1280 × 960 (4 VGA), VGA	
Frame Rate	MPEG-4 30 fps @ VGA, MJPEG 15 fps @ 1280 × 960	
Image Setting	Brightness, Exposure, Sharpness, Contrast, White Balance, Image Rotation	
Audio	Two-way Audio	
Alarm	Input	5V 10kΩ pull up
	Output	Photo relay output 300 VDC/AC
Network		
Interface	10/100 Ethernet (RJ45)	
Protocol	TCP/IP, UDP, RTP, RTSP, HTTP, ICMP, FTP, SMTP, DHCP and IGMP	
Password Levels	User and Administrator	
Internet Browser	Internet Explorer (6.0+)	
User Account	20	
General		
Operating Temperature	0 °C ~ 50 °C	
	Humidity: 10% to 90%, Non-condensing	
Power Source	DC 12V / PoE / AC 24V	
Power Consumption	4.2W (max. 350mA @ DC 12V)	3W (max. 250mA @ DC 12V)
Certificate	CE, FCC, RoHS compliant	

Product Selection



NH060-



Sensor 1: VGA Super HAD 3: 1.3M CCD 4: 1.3M CMOS	Lens Type 0: CS mount type 1: CS mount type, D/N A: Varifocal 3.3 ~ 12 mm B: Varifocal 3.3 ~ 12 mm, D/N	Power 1: DC 12V 2: DC 12V & PoE 3: DC 12V & AC 24V & PoE	IR LED 0: w/o	Frequency 5: 50 Hz 6: 60 Hz	WDR 0: w/o W: w/
------------------------------------------------------------------	----------------------------------------------------------------------------------------------------------------------------	--------------------------------------------------------------------------	-------------------------	------------------------------------------	-------------------------------



NH070-



Sensor 3: 1.3M CCD	Lens Type T: 10x zoom, 4.95 ~ 49.5 mm	Power 2: DC 12V & PoE 3: DC 12V & AC 24V & PoE	IR LED 0: w/o	Frequency 5: 50 Hz 6: 60 Hz	Features 0: w/o R: RS-485 1: RS-485+BNC
------------------------------	-------------------------------------------------	-------------------------------------------------------------	-------------------------	------------------------------------------	---------------------------------------------------------



NH101-



Sensor 4: 1.3M CMOS	Lens Type 2: Fixed focal 4.3 mm	Power 4: PoE	IR LED 0: w/o	Power Plug 0: None M: M12 R: RJ45 Cable	Frequency 5: 50 Hz 6: 60 Hz	Microphone 0: w/o 1: w/
-------------------------------	-------------------------------------------	------------------------	-------------------------	---------------------------------------------------------	------------------------------------------	--------------------------------------

* Microphone feature is only available in standard models



NH210-



Sensor 1: VGA Super HAD 3: 1.3M CCD 4: 1.3M CMOS	Lens Type A: Varifocal 3.3 ~ 12 mm B: Varifocal 3.3 ~ 12 mm, D/N	Power 1: DC 12V 2: DC 12V & PoE 3: DC 12V & AC 24V & PoE	IR LED 0: w/o	Frequency 5: 50 Hz 6: 60 Hz	WDR 0: w/o	Heater/Fan 0: w/o H/F 1: w/ H/F
------------------------------------------------------------------	-------------------------------------------------------------------------------	--------------------------------------------------------------------------	-------------------------	------------------------------------------	----------------------	----------------------------------------------

* H / F is needed to collocate with AC24V model