



4-ViLa

4-WIRE
INTERCOM SYSTEM

4-wire VT-2795 Expandable Kit

Kit Description

This 4 wire kit is the most economical and competitive solution of ONE-FAMILY video door entry system.

All items are easy to install and operate for user. Functions such as lock release, monitor, talk and point to point intercom. Indoor monitor with two colors for choice.



Packing List



| Item | Model | Quantity |
|--------------|--------------|----------|
| Door station | VT595/C/RH | 1 |
| Monitor | VT27(SD)/TD7 | 1 |
| Power supply | PS4-24V(C3) | 1 |

Example of one-to-one Wiring

Door station features



Monitor features

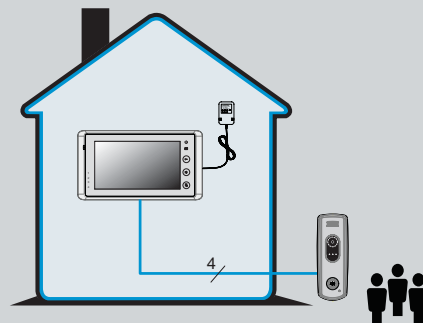

Multi Door Stations & Monitors Connection

- 2 outdoor stations connected directly
- Max.4 door stations/CCTV cameras
- Max.5 indoor monitors in one family
- If door station is more than 2 and less than 4, must use MDS unit.
- The master monitor must use VT27SD/TD7 model to support the memory sharing function.

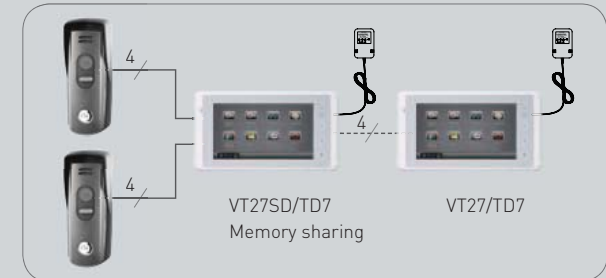

Quad Monitoring Connection

- Max.4 door stations or CCTV cameras via VT-QSW unit
- 4 pictures can be previewed at the same time
- Each picture can be seen individually, just touch the picture

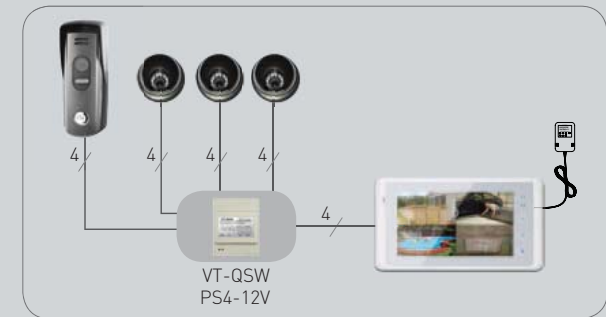

Extra Functions

- The staircase light function via RLC
- The outdoor station can use the keypad access to control the door

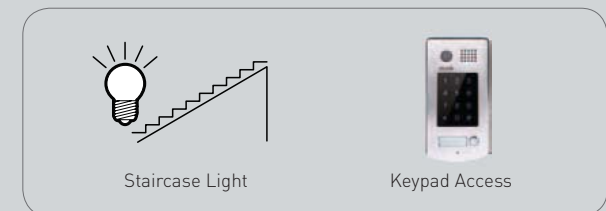

4-wire VT-2491 Expandable Kit

Kit Description

This 4 wire kit is the most economical and competitive solution of ONE-FAMILY video door entry system.

All items are easy to install and operate for user. Functions such as lock release, monitor, talk and point to point intercom. Indoor monitor with two colors for choice.



Packing List



| Item | Model | Quantity |
|--------------|-------------|----------|
| Door station | VT591/C/RH | 1 |
| Monitor | VT24(P)/D4 | 1 |
| Power supply | PS4-24V(C3) | 1 |

Example of one-to-one Wiring

Door station features



Monitor features

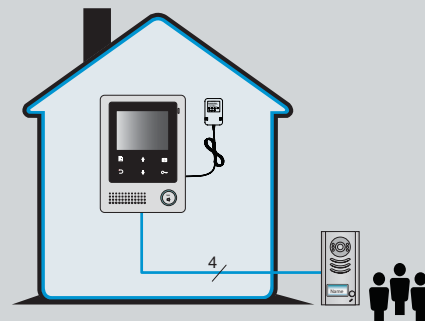

Multi Monitors Connection

- Max.5 indoor monitors supported

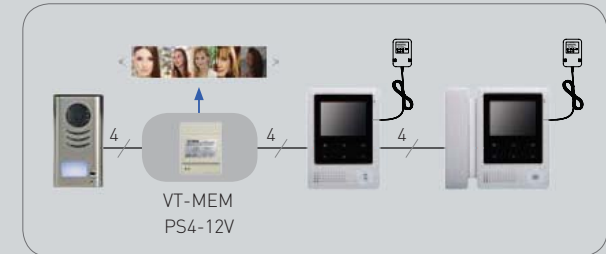

Multi Door Stations Connection

- Max.4 door stations or CCTV cameras via MDS unit
- Max.5 indoor monitors in one family
- Inner call or point to point intercom
- Different ring tone and ring tone volume setting

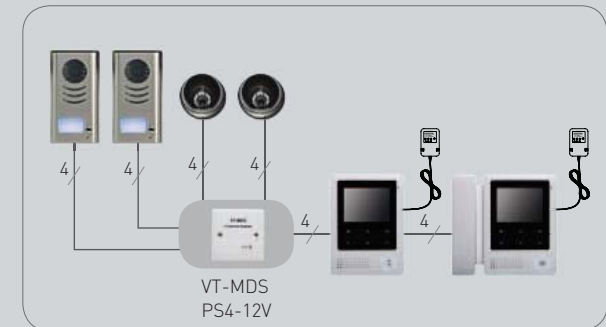

Additional Handset



4 Wire System Product List



Gift box for kit

Nowadays 4-wire indoor monitor has been more high-fidelity audio to guarantee great acoustic performance in hand-free and handset mode. They are still compatible for all outdoor stations in 4-wire system. As advanced, they fulfill the desire for extending the function concepts, such as the picture memory sharing, CCTV camera connection, stair light control, quad monitoring. The outdoor stations still provide each and every day with a remarkable experience, whether with its multifunctionality with video or audio, flush-mounted or surface-mounted. They still ensure the safety for your home.

| Description | |
|-------------|--|
| 01 | Door Station VT591/C/RH Sharp color CCD outdoor station with rainy cover, zinc alloy panel, white led light |
| 02 | Door Station VT592/C/RH Sharp color CCD outdoor station with rainy cover(two buttons), zinc alloy panel, white led light |
| 03 | Door Station VT596/KP Color ARS outdoor station with rain cover (keypad access version), stainless steel panel |
| 04 | Door Station VT584/C Color CCD outdoor station, high white led light |
| 05 | Door Station VT595/C/RH Color outdoor station, zinc alloy housing, high resolution ARS-105° camera |
| 06 | Handset HS24 Handset audio phone for VT24 series |
| 07 | Monitor VT24/D4 4 inch digital color TFT screen monitor, touch sensor button operation, text menu. Monitor VT24P/D4 Build-in SMPS power supply(optional) |
| 08 | Monitor VT27/TD7(White) 7 inch digital color TFT screen monitor with touch screen operation & white housing, color icon menu VT27SD/TD7(White,with picture memory) |
| 09 | Monitor VT27/TD7(Black) 7 inch digital color TFT screen monitor with touch screen operation & black housing, color icon menu VT27SD/TD7(Black,with picture memory) |
| 10 | Power Supply PS4-24V(C3) Power supply, 24V 1A DC outputs, din rail mounting |
| 11 | Light Actuator VT-RLC Light control(VT) |
| 12 | Memory Unit VT-MEM Public memory unit (4 inch monitor only) |
| 13 | Quad Switcher VT-QSW Quad switcher unit (7 inch monitor only) |
| 14 | DS Switcher VT-MDS Door station switcher(4 inputs) |
| 15 | Distributor VT-BDU Distributor with 86*86 box mounting |



2EASY

2-WIRE
INTERCOM SYSTEM

2 Wire System Description

The 2 WIRE SYSTEM is the best technology for those cases when TIME SAVING and EASY INSTALLATION are crucial. Thanks to the non polarized 2 wire system, it is in fact possible to install, with the same ease, all kinds of systems, from those for single villas to those for apartment complexes.

- Max. 32 Monitors in a system
- Max. 4 Door Stations
- Max. 6 CCTV cameras

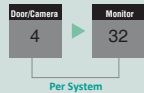

System Application

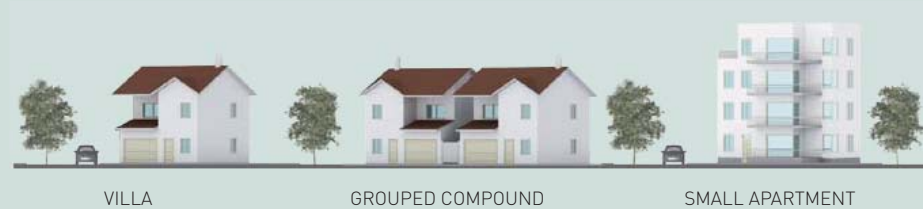

System Advantage

Easy to Update Interface

Use simulator to edit and export Config data to SD card, insert SD card to the monitor to update UI data (depends on model).

Advanced Data Managing

The data such as screen logo, user namelist, can be uploaded from PC to doorstation, and doorstation will send data to monitor automatically.



DIP Switches Setting

Use DIP switches to set the monitor address, other settings will be finished easily on the screen.

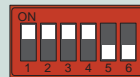

Plug-In Connector

With the Plug-In connector, you can set up the system fast and funny!



2Easy Integrated Functions

INTERCOM

- Up to four monitors per apartment with inner call
- Point to point for users with namelist dialing
- Shared video recording memory to get high value in minimum cost

ACCESS CONTROL

- Keypad or RFID card access is available
- Most Door Stations support 2nd Lock directly
- Support timed unlock using inner powered or Dry-contact
- Additional relay actuator for heavy load locks

IP NETWORK

- IP network makes standalone 2-wire systems working together, for complex residential blocks
- Users can call Guard Station at any time

VIDEO SURVEILLANCE

- Analog cameras can be connect into system by means of DT-DCU
- 2-wire cameras (DT-CAM) can be connected to DT-SC6V directly
- Camera views can be recorded as well as Door stations

GSM/TELEPHONE GATEWAY

- Answer the call and open the door from remote telephone or mobile phone
- Gateway for analogue telephone line by means of DT-TPC or DT-TPS
- Work with the mobile GSM network by means of DT-GSM

INTRUSION ALARM INTERGRATED

Available by 2014.Q2

- Alarm system can be integrated in the video door phone service
- 4 wired zones and 16 wireless zones supported
- Siren or strobe light activation
- Alarm signal is transferred to Monitor, GSM or Guard Station

2 Wire System Application

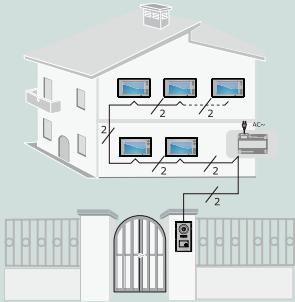

Cable and Distance

| Cable | A(m) | B(m) ≤ 2 IM | B(m) ≤ 16 IM |
|--|------|----------------|-----------------|
| CAT5 Cable (Combined) | 40 | 80 | — |
| Pair Cable (Parallel) 2X0.75 mm ² | 30 | 50 | — |
| Twisted Cable 2X0.75 mm ² | 60 | 100 | 40 |
| Twisted Cable 2X1.0 mm ² | 80 | 120 | 60 |

Extending Monitors(up to 16)

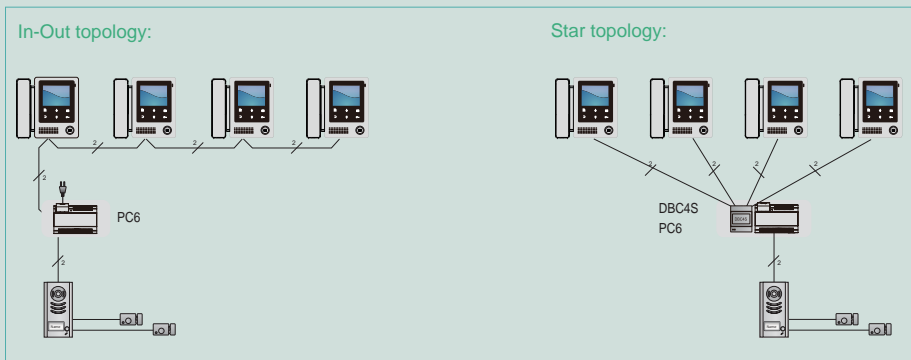

Extending Door/CCTV Cameras

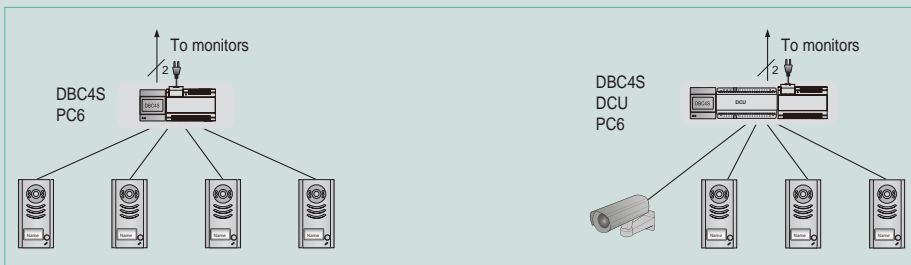

Connection Diagram

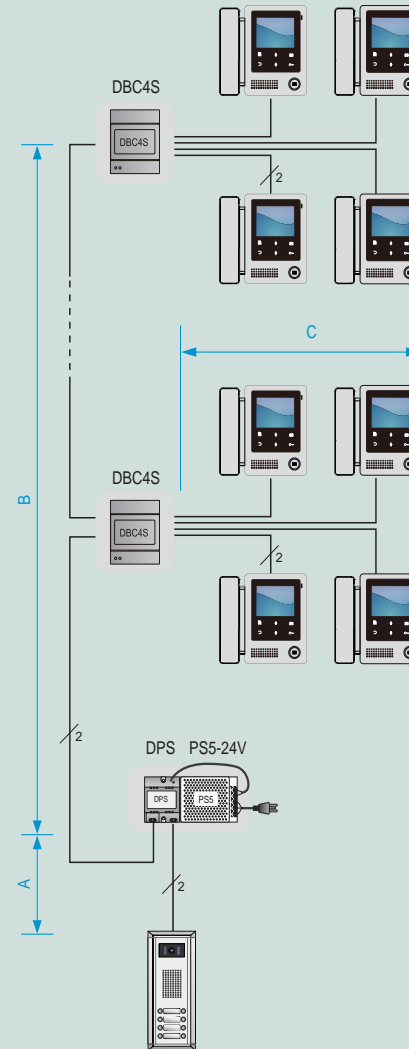

Cable and Distance

The maximum distance of the wiring is limited in the DT system. Using different cables may also effect the maximum distance of the system can reach.

When Monitor Quantity < 20

| Cable Usage | A | B | C |
|-------------------------------------|----|----|----|
| Twisted cable 2x0.75mm ² | 60 | 60 | 30 |
| Twisted cable 2x1 mm ² | 80 | 80 | 40 |

When Monitor Quantity > 20

| Cable Usage | A | B | C |
|-------------------------------------|----|----|----|
| Twisted cable 2x1 mm ² | 70 | 30 | 20 |
| Twisted cable 2x1.5 mm ² | 70 | 50 | 30 |

Cables should be non-shielded! And the twisted cables are recommended, if non-twisted cable is used, the total distance will remain only to half.

2 Wire System Product List



01



02



03



04



05



06



07



08



09



10

Already nowadays 2-wire indoor monitor has been easier to use and flexible for installation solutions. As standardized, they are compatible for all outdoor stations in 2-wire system. As advanced, they fulfill the desire for extending the function concepts, such as telephone divert, CCTV camera connection, picture sharing, alarm function etc.

Description

- | | |
|----|---|
| 01 | Monitor DT27/TD7(White) 7 inch digital color TFT screen monitor with touch screen operation & white housing, OSD menu |
| | Monitor DT27SD/TD7(White) 7 inch digital color TFT screen monitor with touch screen operation & picture memory & white housing, color icon menu |
| 02 | Monitor DT27/TD7(Black) 7 inch digital color TFT screen monitor with touch screen operation & black housing, OSD menu |
| | Monitor DT27SD/TD7(Black) 7 inch digital color TFT screen monitor with touch screen operation & picture memory & black housing, color icon menu |
| 03 | Monitor DT47/TD7 7 inch digital color TFT screen monitor with capacitive touch screen operation & black housing, color icon menu |
| 04 | Monitor DT37/TD7 7 inch digital color TFT screen monitor with touch screen operation, color icon menu |
| 05 | Monitor DT21SD/TD10 10 inch digital color TFT screen monitor with touch screen operation & picture memory, color icon menu |
| 06 | Monitor DT16/D3 3.5 inch digital color TFT screen monitor with white housing, text menu |
| 07 | Monitor DT16/D3/AL 3.5 inch digital color TFT screen monitor with aluminum front panel, text menu |
| 08 | Monitor DT25/D4 4 inch digital color TFT screen monitor, text menu |
| 09 | Monitor DT24/D4 4 inch digital color TFT screen handset monitor, touch sensor button operation, text menu |
| 10 | Monitor DT39/D4 3.9 inch digital color TFT screen handfree monitor, touch sensor button operation, text menu |

2 Wire System Product List



01



02



03



04



10



11



05



06



07



08



09



12



13



14

Today all outdoor stations are increasingly available for easy installation on all villas and small buildings either for surface mounting or flush mounting. With high protection against unauthorised access to get much greater comfort and safety. This ensures that only pleasant surprises gain access to your home.

Description

- | | |
|----|---|
| 01 | Door Station DT591/C/RH Sharp color CCD outdoor station with rainy cover, zinc alloy panel, white led light |
| 02 | Door Station DT592/C/RH Sharp color CCD outdoor station with rainy cover(two buttons), zinc alloy panel, white led light |
| 03 | Door Station DT594/C Sharp color CCD outdoor station with plexiglass panel |
| 04 | Door Station DT595A Audio outdoor station, zinc alloy housing |
| 05 | Door Station DT596SF/KP Color CCD outdoor station by flush mounting (keypad access version), stainless steel panel |
| 06 | Door Station DT596SF/ID Color CCD outdoor station by flush mounting (proximity access version) |
| 07 | Door Station DT597/C Color outdoor station, medical S316 stainless steel panel, high resolution ARS-105° camera, adjustable visual angle |
| 08 | Door Station DT601/KP Color ARS outdoor station with rain cover (keypad access version), stainless steel panel |
| 09 | Door Station DT601/ID Color ARS outdoor station with rain cover (proximity access version), stainless steel panel |
| 10 | Door Station DMR12/ID/S4 Color CCD outdoor station with proximity access control (4 buttons), high resolution ARS-105° camera |
| 11 | Door Station DMR12/D16 Color CCD outdoor station (16 buttons), high resolution ARS-105° camera |
| 12 | Door Station DMR11/S4 Color CCD outdoor station (4 buttons), high resolution ARS-105° camera, aluminum panel |
| 13 | Door Station DMR11/ID/S4 Color CCD outdoor station with proximity access control (4 buttons), high resolution ARS-105° camera, aluminum panel |
| 14 | Door Station DMR18/ID/RH Color outdoor station with TFT screen display & ID proximity access & rainy cover |

2 Wire System Product List



01



02



03



04



10



11



05



06



07



08



09



12



13



14



15

More and more accessories are designed for stronger extending solutions. Like telephone GSM function,DVR output,picture memory sharing ,CCTV camera connecting and so on.

Description

| | |
|----|---|
| 01 | Power Combo PC6 Power combo unit, 26V 2A DC outputs |
| 02 | Power Supply PS5-24V Power supply with din rail, 24V DC outputs |
| 03 | IP Gateway DT-IPC IP gateway converter(DT) |
| 04 | Telephone Interface DT-TPC Telephone interface converter(DT) |
| 05 | Camera controller DT-SC6 2 wire camera controller,2 inputs(DT) |
| 06 | Power Supply PS4-24V(STD) Power supply, 24V 1A DC output, din rail mounting |
| 07 | Distributor DT-DBC Branch controller |
| 08 | Distributor DT-DBC4S 4 outputs/inputs branch controller |
| 09 | Power Separator DT-DPS Power separator |
| 10 | 2-wire Camera DT-CAM Sony 1/3 inch CCD camera with bracket, infrared led, 20 meters |
| 11 | Camera Interface DT-DCU CCTV camera control unit, 2 inputs |
| 12 | Desk Bracket DB1-B(Black) Desktop Bracket White desktop bracket optional. |
| 13 | Handset Audio Phone DT-DJ4S Handset audio phone with touch sensor button |
| 14 | Video recorder DT-SC6V Public video recorder with micro SD card(DT) |
| 15 | GSM interface DT-TPS GSM & telephone interface converter(DT) |



K5
INTERCOM SYSTEM

K5 System Description

The K5 system is based on standard Cat-5 cable and RJ45 connector, K5 system has achieved significant breakthrough in such traditional bottleneck as SWS wiring, signal transmission wiring difficulty, it makes the installer's job easier and faster by reducing the costs and process for projects and increasing the anti-interference capacity as well. Furthermore, TCP/IP based networking makes the system much more stable for big building community.



System Application



LARGE RESIDENTIAL COMPOUND



COMMERCIAL BUILDING



EDUCATIONAL SECURITY

System capacity

- Max. 512 apartments per block
- Max. 8 door stations per block
- Max 3 monitors in one flat
- Max. 239 blocks in network
- Max. 14 Switchboards per system(6 PC+8 IP-G21)

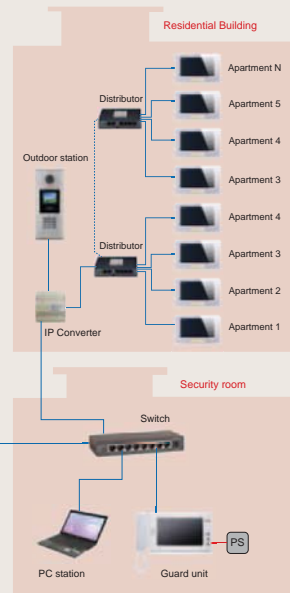
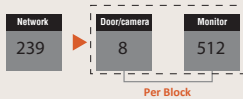

System Advantage

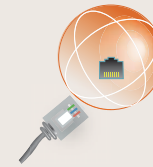

Easy to setup

Using the Cat-5 cables for the whole system, it will be possible to wire the cables through existing network without the need for any masonry work to save the cost.

Long distance of signal transmission

The system automatically equalizes and amplifies the audio and video signal, restoring high quality performance even for long distances using Cat-5 cable.

Signal separation technology

With signal separation technology, each monitor has its own signal channel, to make sure that any malfunction on the monitor side won't shutdown the system.



System Features

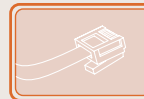

RJ-45 Connector

Using the standard RJ-45 connector, easy to install and maintain. greatly reduces the cost and process for the project.

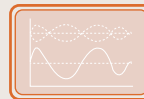

Differential signal transmission

The system automatically equalizes and amplifies the audio and video signal, restoring high quality performance even for long distances using



Four channels and point to point intercom

With signal separation technology, each monitor has its own signal channel, to make sure that any malfunction on the monitor side won't

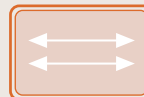

Double channel communication

It enables two visitors call and communicate with two different residents at the same time.

K5 System Advantage

Double Channel Communication



Two visitors can call and communicate with two different residents at the same time in the same building, or two residents are using room-to-room intercom with each other while a visitor is calling the third resident.

Multi Switchboard based IP Network

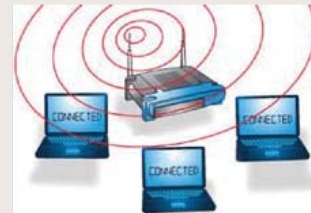

The resident can communicate with a neighbor in the other apartment. They can be in the same or different building.

Room-to-room Intercom



The resident can communicate with a neighbor in the other apartment. They can be in the same or different buildings.

Home Alarm Security



4 or 8 independent alarm zones, no limit on the number of sensors(motion detector,IR sensor,gas detector etc..) per zone.

Intergrated Memory



The resident can capture and save picture of the visitor automatically or manually.

Multi Language Message



The resident can receive the message like important notices from guard unit.

K5 System Wiring

Standalone Building

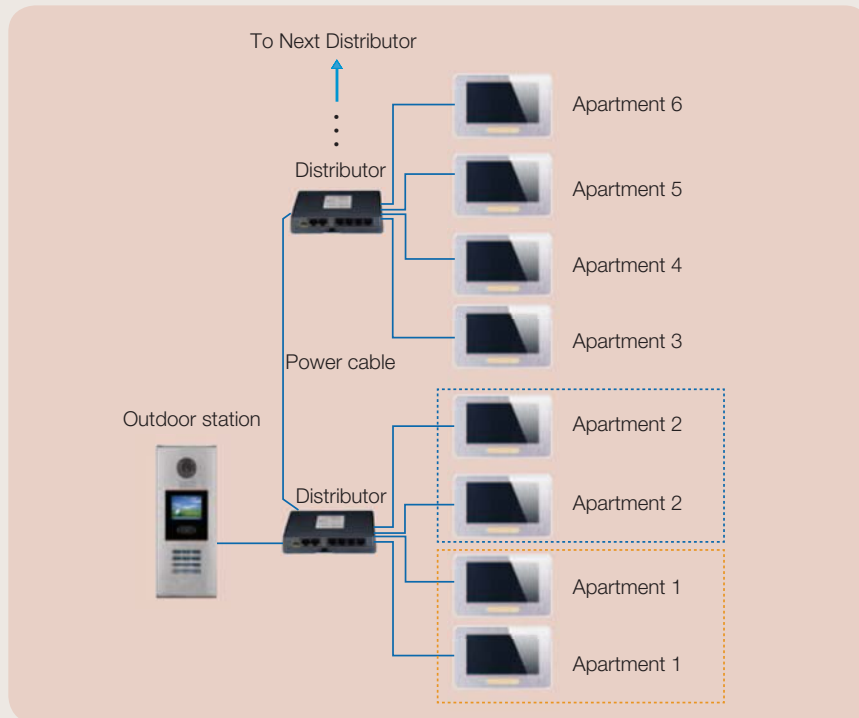

Cable limitation and power distribution table

| Power distribution | Voltage | DC24V | |
|--|--|---|----------------------------------|
| | Monitors | Standard monitor | One power supply for 20 monitors |
| With second door station | | One power supply for 12 monitors | |
| With Alarm-detector powered by monitor | | One power supply for 8 monitors (One power supply can feed at least 8 monitors under all circumstances) | |
| Door station | One power supply for each door station | | |
| Other devices | Share power supply with door station | | |
| Cable | Cat5(BUS) | RVVP2*1.0(Power) | |

Networked Blocks

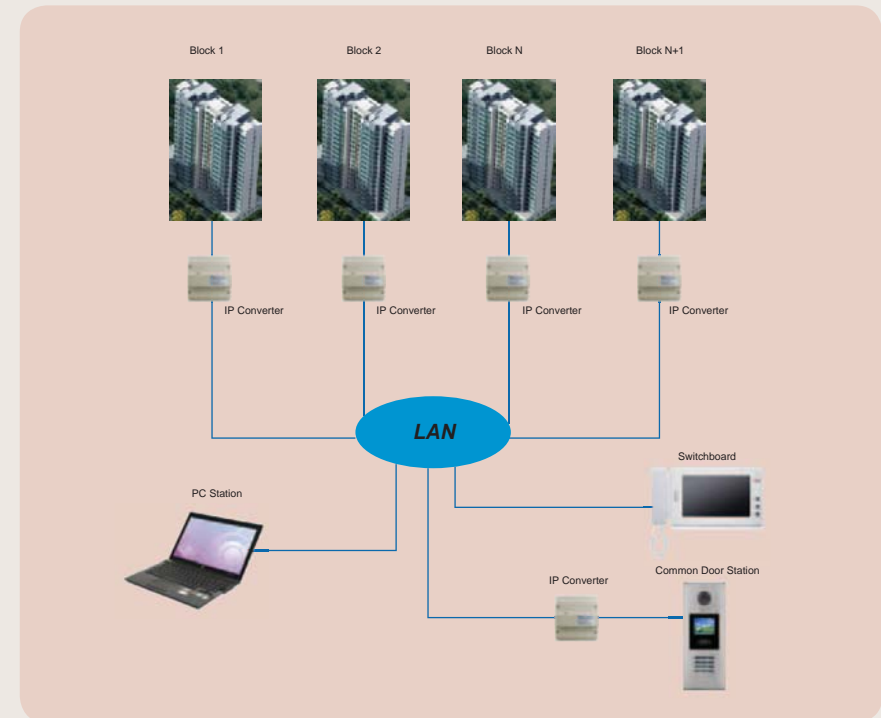

Under the TCP/IP based networking, it can support the big building community. Max. 238 buildings can be connected in network. No worries on network connection distance limitation. What's more, it can detect the system status easily. Debugging and maintenance will be done with computer.

K5 System Product List



01



02



03



06



04



05



07

Description

- 01 **Monitor C5-AT24/D4**
4 inch digital color TFT monitor(CAT5), text menu

- 02 **Monitor C5-AT34/D4**
3.8 inch digital color TFT monitor(CAT5), text menu

- 03 **Monitor AT2/C7**
7 inch color TFT screen monitor, text menu

- 04 **Monitor C5-AT27/TD7(White)**
7 inch digital color TFT screen monitor with touch screen operation & white housing, 4 alarm zones, color icon menu

- 05 **Monitor C5-AT47/TD7(Black)**
7 inch digital color TFT screen monitor with touch screen operation & black housing, 4 alarm zones, color icon menu

- 06 **Door Station IP-MR18/ID/RH**
Color outdoor station with TFT screen display & ID proximity access & rainy cover

- 07 **Door Station IP-MR28/ID/RH**
Color outdoor station with TFT screen display & ID proximity access

Simple and economical models can be strategically found in K5 system to meet holistic desires. They are still easily to install and use either the hand-free indoor or handset indoor.

K5 System Product List

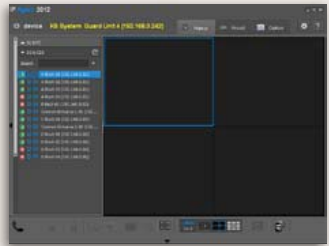

01



02



03



04



05

Description

- | | |
|----|---|
| 01 | K5 system IP agent software kit |
| 02 | Guard Station IP-G21 10 inch digital color TFT screen guard station with touch screen operation |
| 03 | IP Gateway C5-IPC IP gateway converter(C5) |
| | Distributor C5-F414 4 outputs distributor, 4 audio channels, 1 video channel |
| 04 | Distributor C5-F422 4 outputs distributor, 2 audio channels and 2 video channels |
| | Distributor C5-F411 4 outputs distributor, 1 audio channels, 1 video channel |
| 05 | Power Supply PS5-24V Power supply with din rail, 24V DC outputs |

With the IP-AGENT software, like the guard unit, it can make the function of video surveillance, intercom communication, recording, playing, answering calls and door release etc. It is convenient and effective for estate management.