

Fingcas & Access Control System

The access control system is installed and used in a place or area that requires access control such as government offices, offices, factories, buildings, laboratories, financial companies, and etc. You can open the door from your mobile phone, you can receive emergency signals in real time in case of illegal intrusion, you can check the T & A status.



Greetings

Hello ?

We are a company that develops and manufactures access control system.

The product is a product developed by a technician with development experience and knowledge of the same kind industry over ten years.

We are doing our best to make products that are consistent with market conditions and operate stably without failure.

We are developing and supplying fingerprint readers & controllers and RF card readers & controllers etc, which were created by developing our own optical fingerprint module.

In addition, an access control program(Model: GuardEyes) that can be connected to a network product can be installed on a large door as well as a medium- and small-sized scale.

And we think that we can respond to customers' request with various functions according to installation environment.

We will also strive constantly to be a trusted company by thoroughly ex-post management of the supplied products.

Thank you very much.

Contact

Company : Fingcas Corp.

Address : Rm 201 Bugang Bldg., Buheung-ro Bucheon-si,
Kyunggi-do, Korea

Phone and mobile : 82-32-664-8418 / 82-10-2770-8418

Website : www.fingcas.com

E-mail : andk9@naver.com, kskim12@gmail.com

Access Control System

Access control system means to limit the number of people entering the important places and to keep the access record data in order to secure a comfortable space and safety.

The main purpose of access control is to protect private property from unspecified number of people, security of belonging personnel, blocking of information leakage, and efficient management of facilities.

Access control system works by setting up the contents of access permission for entry and exit so that you can enter and exit the door allowed in the permitted time.

In addition, all information related to entry and exit is automatically saved, and the operator provides the function to search and display the saved data.

Access control system can be applied to all systems that use ID recognition such as time attendance management and vehicle management besides security and security purpose.

Access control systems can also have synergies through interfacing with other systems in the IBS building, including fire, air conditioning, lighting, power, and elevators.

For reference, our GuardEyes program is a program that can manage access and simple time and attendance, and can install the GuardEyes Mobile App on a mobile phone to remotely receive access confirmation and illegal intrusion alarm.

Access control system configuration

Component	Contents of configuration	Fingcas Products
Operating program	Windows 7,8,10, operation software & Android Phone	GuardEyes program & Mobile App
Controller & Reader	Data read, register, save, delete and communication	FM2000, FR200, FR260
Controller	Data storage and communication function	FC3400 controller
Reader	Data(password, RF card, fingerprint) recognition function	FR500 RF card reader
Electric Lock	Deadbolt lock, EM lock, Electric Strike	Other company products
Exit Device	Sensor, Switch, Exit Button, etc	" " "

Access control system configuration (Stand-alone system)

With the RF reader & controller product, you can register, save, delete ID / card / password and manage the door.

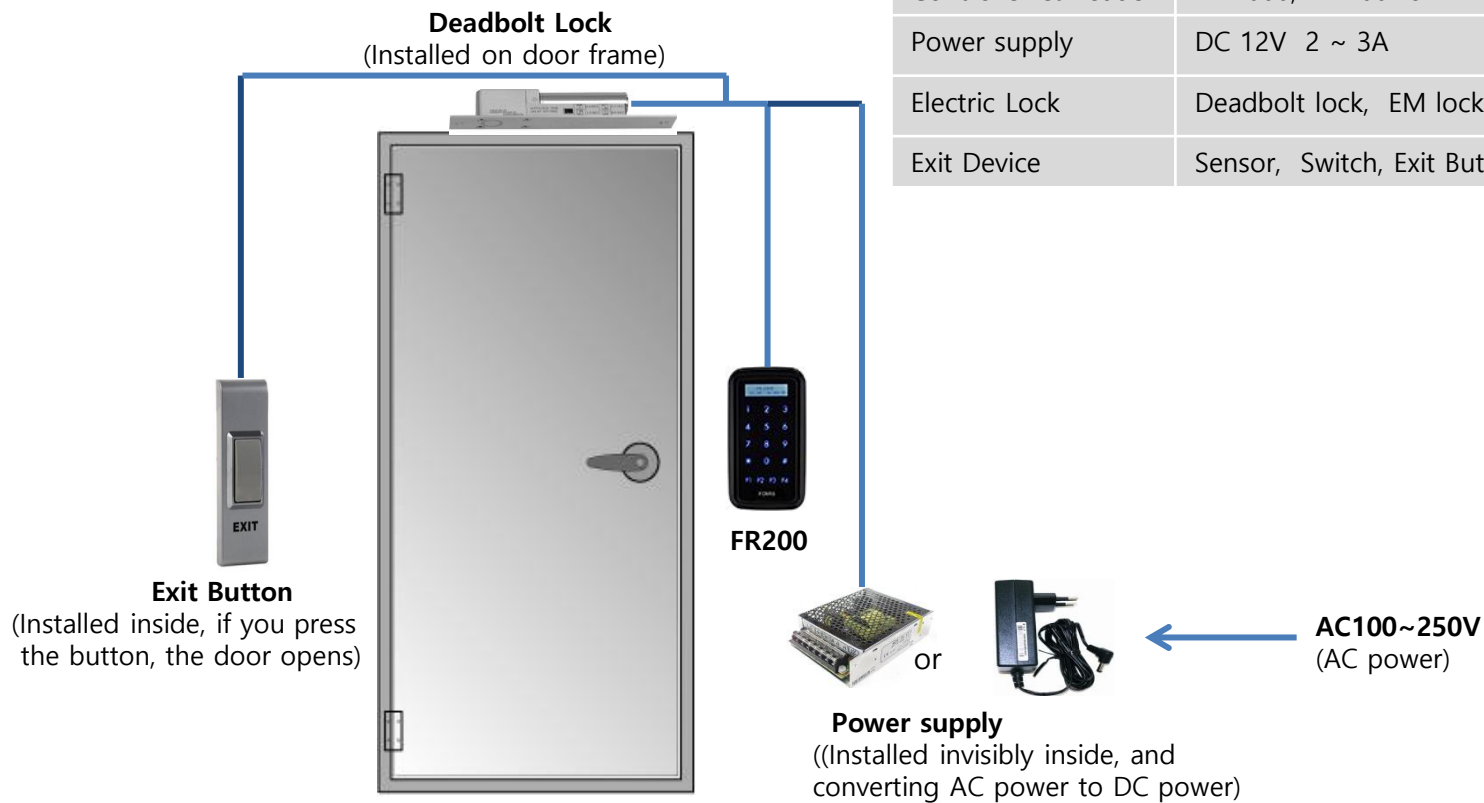

Component	Content by component
Controller & Reader	FM2000, FR200 or FR260
Power supply	DC 12V 2 ~ 3A
Electric Lock	Deadbolt lock, EM lock or Electric Strike
Exit Device	Sensor, Switch, Exit Button, etc

Access control system configuration (Network system)

You can directly control the FM2000 product connected to the LAN from the operation PC, and register, save, delete ID / card / fingerprint on the PC, and perform simple time and attendance management.

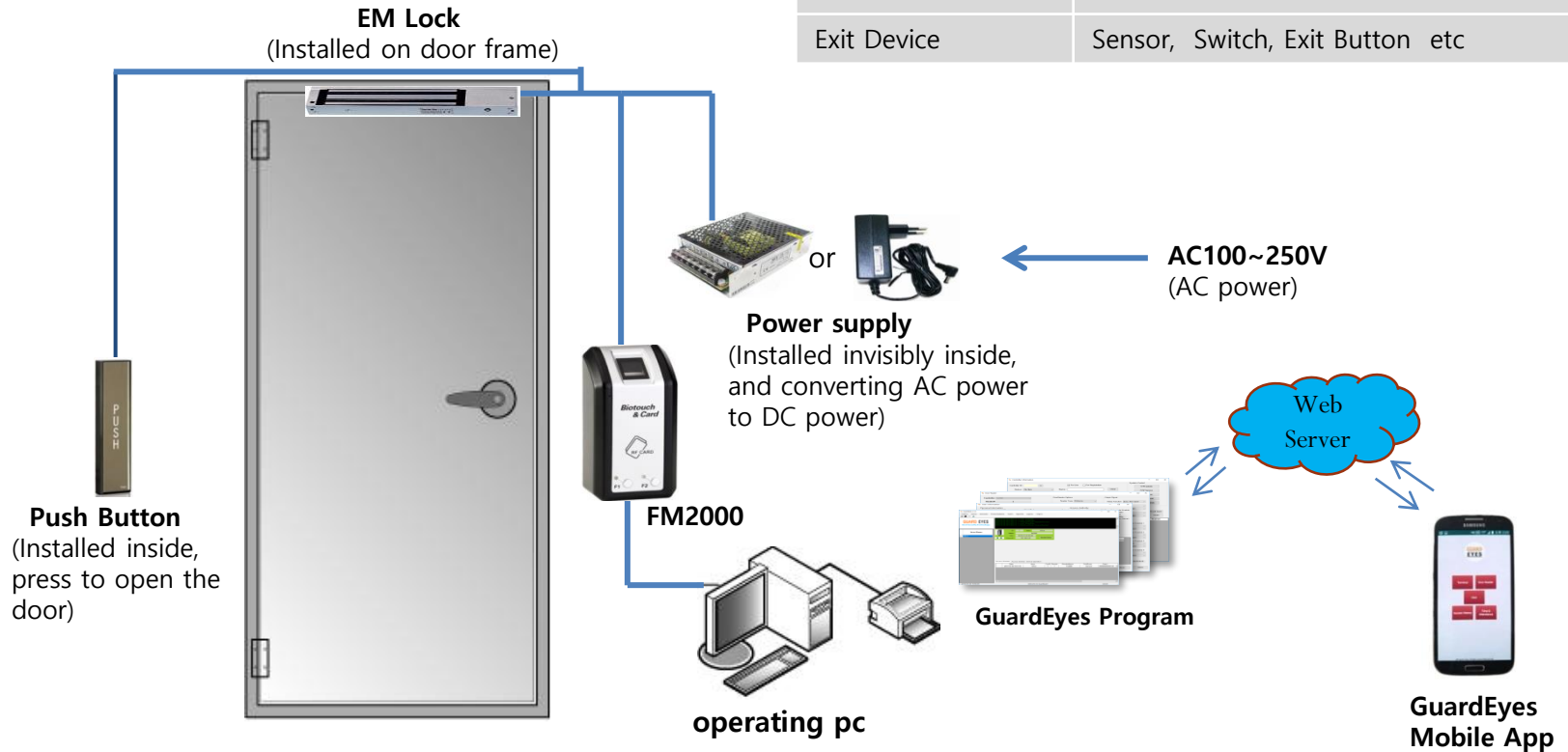

Component	Content by component
program	GuardEyes program & Mobile App
Controller & reader	FM2000, FR200, FR260 or FC3400
Power supply	DC 12V 2 ~ 3A
Electric Lock	Deadbolt lock, EM lock or Electric Strike
Exit Device	Sensor, Switch, Exit Button etc

Access control system configuration diagram (Network system)

Up to 253 LAN communication can be connected to the operating PC regardless of the controller type.

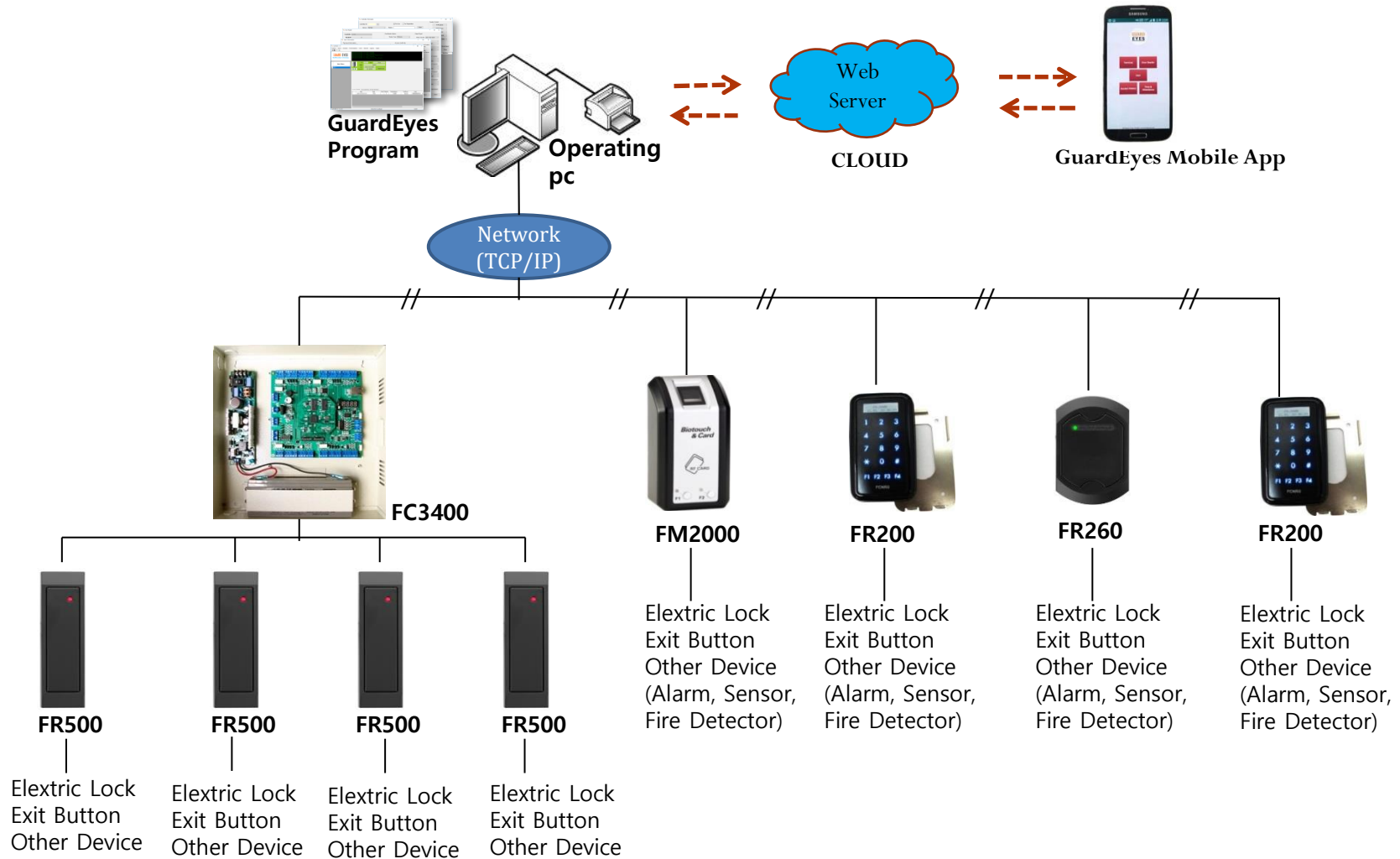

Product Description

The GuardEyes program allows you to build large-scale access control systems as well as small to medium-sized access control systems. In addition, access events can be searched for simple time and attendance management.

It is installed in Windows OS 7, 8, 10 and operates by TCP / IP (LAN) communication.

GuardEyes Program

Access Control Software



Main Features

- The program can be operated in Korean, English or Japanese.
- It has the function to register, save, change and delete ID / fingerprint / card / password of registered user.
- There is a function that shows the registered user's access sign in real time on the main screen.
- In order to solve problems caused by pc damage or replacement, it is possible to save and restore the registered user list to external USB or storage media.
- There is a function that can save registered user and controller list in Excel file and manage it.
- There is a function to remotely manage doors (temporary opening, opening open, closing open) from the PC.
- If the door is forcibly damaged or opened, there is an alarm function displayed in red on the main screen.
- When it is linked to a fire detector, it has a function to notify the occurrence signal of a topic.
- There is a function that can restrict user access by hourly and simple time and attendance management.
- Most of the functions necessary for access control are built in.

Fingcas Product

Product Description

GuardEyes mobile app can be installed on the Android mobile phone (cell phone) and connected to the PC (GuardEyes program installation) installed in the field, you can see the attendance management of the door and receive alarm signals when the door is damaged.

GuardEyes Mobile App

Web Sever & Mobile App



Main Features

- Mobile phone holders must register their mobile phone number in advance in the GuardEyes program. Then download and install the GuardEyes mobile app from the Google Play Store.
- You can check the operation status of the controller and card reader installed on the site as an access control system
- You can open the door remotely from your mobile phone.
- When the door is damaged, such as illegal intrusion from the mobile phone, you can receive alarm signals in real time, so you can respond to the door security more quickly.
- You can check the registered user list on your phone.
- From your mobile phone, you can remotely check the Time and Attendance Management (by individual, period, department, etc.) of registered users.
- One mobile phone can manage multiple sites.

Product Description

The FC3400 controller consists of a PCB board, a power supply, and a rechargeable battery. The FC3400 controller is mainly installed in important facilities because it has a large event storage capacity and can prevent sudden interruption of power supply.

In addition, the access controller(FC3400) has a controller function, so you have to connect a separate reader (fingerprint reader, RF card reader, or keypad reader) and control four doors.

FC3400

Access Control Terminal



Main Specification

Division	FC3400 Specifications
CPU	400MHz 32bit Microprocessor
Program / memory	64MByte SDRAM / 128Mbyte NAND Flash Memory
Power/communication	12V / 1.5A or more / RS232, RS422, RS485, Ethernet
ID registration / event storage	Save 200,000 users / 400,000 events
Reader port	4 Wiegand: 26bit ~ 96bit automatic recognition, 4 / 8bit Burst for PIN 1 fingerprint reader and R / W Mifare card support
Input port	16 (4 exit buttons, 4 door states, 8 PC S / W settings such as intrusion detection, fire alarm)
Output Relay (Port)	Relay output 4 pieces / 120VAC 0.5A, 24VDC 1A TTL output 8 pieces / DC5V Maximum rated current 40mA
LED indicator	Communication status 8, Output status 4, Power 1, Operation status and Self-check result display 7-Segment LED 4
Buzzer	Piezo buzzer
Size (W x H x T)	Iron plate case(320 x 320 x 63mm), PCB(182 x 175 x 25mm)
Weight (PCB, finished product)	300g (pcb only), 3.2Kg (PCB, power supply, rechargeable battery, case with steel case),

Product Description

FM2000 has built-in recognition(fingerprint and RF card) function and controller function, and it guides to voice during operation. The fingerprint is recognized by the optical method, and the RF card can be used both as an EM card and as a Mifare card. FM2000 can be connected to the program(GuardEyes) by TCP/IP communication and can control access control as well as simple time attendance. And you can install and use it alone without internet connection. To install the FM2000 as an access control system, you must have a GuardEyes program, a lock device, and an access button.

FM2000

Access Control
Fingerprint
Reader



Main Specification

Division	Specifications
Power Consumption	Max. DC 12 ± 3 V 300 mA
Communication Interface	10/100 base ethernet
Fingerprint Sensor	Optical Sensor
1:1 Verification/1: 1,000 Identification Time	800 msec / 970 msec
Template Size	256~384 Bytes (configurable, 384 Bytes default)
Template Capacity	1,900 at 1 MB flash (option: 9,500 at 4 MB flash)
RF Card Interface/Event Log	Max. 65,000 / Max. 100,000
Display / Keypad	3 Color LED / Finger Start button
CPU / Memory	32 Bit RISC CPU / 16MB RAM, 16MB flash Memory
Signal Interface	1 Output (lock) 2 Input (lock status,Exit button) Wiegand Output
Operating Environment	-20~50°C/Lower than 90% RH(Non-Condensing)
EM/Mifare Reader / size	125 KHz / 13.56 MHz RF reader / 76(W) x 112(H) x 37(D)mm

Product Description

The FR200 operates with built-in recognition(RF card/password) and controller functions, and displays text on the LCD and guides you through the voice. FR200 is connected to PC(GuardEyes installed) via TCP/IP communication, and can control access control as well as simple time and attendance management. If necessary, you can install and use it independently without an Internet connection. The built-in touch sensor displays numbers/symbols, guides you through the voice, and makes the numbers/symbols invisible when needed. The access control system consists of FR200 GuardEyes program, lock device(EM lock or dead bolt lock) and exit button as a network, and it has strict access control and time and attendance management.

FR200

Access Control
Card Reader



Main Specification

Division	Specifications
Recognition distance (Mifare card/EM card)	Recognition distance (Mifare card/EM card)
Card/password registration / event storage	Up to 100,000 / 1,000,000
Door open retention time	5 seconds (changeable setting)
Select door lock type	Select Power Fail Safe and Power Fail Secure
Exit button	1 Exit button input (low operation)
LCD display letter / voice guidance	8-Korean or English letter display LCD / Speaker built-in
Power (except electric lock)	DC 12V, current consumption: 150mA ~ 350mA
Operating power	-20°C ~ +65°C, 0~90% Absolute humidity
Color / Size (WxHxD) / Weight	black(Black) / 73 x 126 x 18mm / 250g

Product Description

The FR260 has built-in RF card recognition function and controller function, and it can be connected to PC (GuardEyes installed) via TCP / IP network communication for access control and simple time and attendance management. If needed, you can install and use it alone without an Internet connection.

To install the FR260 as an access control system, additionally operating programs, locking devices, and access buttons are required.

FR260

**Access Control
Card Reader**



Main Specification

Division	Specifications
Recognition distance(Mifare/EM card)	4cm / 10cm (ISO card standard)
Card registration / Event storage	Up to 10,000 / 10,000
Door open retention time	5 seconds (fixed, network adjustable)
Select door lock type	Select Power Fail Safe and Power Fail Secure
Exit button	1 Exit button input (low operation)
Output Type	EM card: 26 bit (Mifare card: 32bit) Wiegand
LED / buzzer	2 Color LED (red, green) / Built-in Piezo buzzer
Power (except door lock)	DC 12V, current up to 150mA(door lock excluded)
Operating environment	-20°C ~ +65°C, 0~90% Absolute humidity
Color / Size (WxHxD) / Weight	Black / 79 x 121 x 18 mm / 100 g

Product Description

FR500 is a card reader with built-in antenna for reading EM card or Mifare card. It is connected to access control controller (FC3400 or similar product) by wiegand communication.

The FR500 does not have a controller function and therefore does not operate alone. It is connected to the controller and operates.

It can be installed on exterior exposed area, aluminum chassis or metal metal wall by epoxy coating.

FR500

Access Control
Card Reader



Main Specification

Division	Specifications
Recognition distance(Mifare/EM card)	4 ~ 7cm / 5 ~ 10cm (ISO card standard)
Power (except door lock)	DC 12V, Max.150mA
Output Type	EM Card: 26 bit (Mifare Card: 32bit) Wiegand
LED / buzzer	2 Color LED (red, green) / Built-in Piezo buzzer
Operating environment	-20°C ~ +65°C, 0~90% Absolute humidity
Color	Dark gray to dull gloss
Size (WxHxD)	42 x 140 x 20mm

Electric lock

The electric lock is chosen based on the installation environment of the door, the required lock tension, and the material and dimensions of the lock. The following products are reference products produced by other companies, and technicians select and install locks according to the installation environment.

EM Lock



Product / Model	Electric Magnet Lock / EM – 600Z
Safe Type	Fail Safe(Open during power failure)
Operating voltage/ current	DC12V / 500mA
Monitoring	LED Display
Wiring	P(+), P(-), COM, NO, NC
Operating temperature	-20° ~ +40°C
Tensile force / material	250KG force / AL 60 series
Product dimensions	250 x 26 x 42mm(LxTxw)
Amateur dimensions	185 x 12.5 x 39mm

DeadBolt Lock



Product / Model	Electric DeadBolt Lock / DB-03
Safe Type	Fail Safe(Open during power failure)
Operating voltage/ current	DC12V / 작동시 670mA
Monitoring	LED Display
Wiring	P(+), P(-), COM, NO, NC
Operating temperature	-20° ~ +40°C
Door position / material	Option / AL 60 series
Product dimensions	200 x 41 x 34mm(LxTxw)
Bolt dimensions(DIA)	15.5mm, Stainless

Electric lock, Switch and Card

The electric lock is chosen based on the installation environment of the door, the required lock tension, and the material and dimensions of the lock. The RF card is an international standard ISO card and a randomly designed RF tag.

Electric Strike



Model	EH401/405
Solenoid ratings	DC24V, 110mA ± 10% / DC12V, 190mA ± 10%
Micro switch 1 / switch 2	Signal for door close, 3A 125V AC / door open, 3A 125V AC
Holding strength	1,362kgs (3,000lbs)
Operation temperature	-25°C ~ 50°C
Functions / Dimension	Fail secure(EH401), Fail safe(EH405) / 76.6mm(W) x 115.6(H) x 19(D)

Exit Switch



Use of Exit Switch	The exit switch is used to connect and disconnect the power line. It is installed inside the door when the access control system is installed.
Exposed switch	120x40x15mm / 138x40x13.5mm
Buried switch	114x69mm / Single box buried switch

ISO card & Tag



EM card or tag	125Khz, 26bit memory
Mifare card or tag	13.56Mhz 32bit memory
Card type	ISO card, Clamshell card, tag card
Operation	Near the card or tag to RF Reader

Product Certificates

Model No.		Cer- tificate	Registration No.	Date of Grant
FM1000	FM1000EM/MF FM1000MF FM1000EM/MF	FCC CE KC	WGPFM1000EM / WGPFM1000MF G106593W BTF-FM1000EM / BTF-FM1000MFM	07/03/2008 2008-07-07 2008-08-26
FM2000	FM2000M FM2000ME FM2000me	FCC CE KC	OD2-FM2000M KT112RC05001 KCC-CMM-FCC-FM2000me	08/21/2012 May 04,2012 2012-04-24
FC3400	FC3400	FCC CE KC	99058 KTI KT112EC09001 KCC-REM-FCC-FC3400	Aug. 08,2012 Sept. 03,2012 2012-08-31
FR200	FR200NM FR200NE FR200NE FR200NM	FCC CE KC KC	OD2-FR200NM Certificate of conformity MSIP-REM-FCC-FR200NE MSIP-CMM-FCC-FR200NM	09/18/2015 Oct. 02, 2015 2015-10-26 2015-10-29
FR260	FR260NM FR260NE FR260NE FR260NM	FCC CE KC KC	WGP-FR260NM KTI15SC07001 MSIP-RMM-FCC-FR260NE MSIP-CMM-FCC-FR260NM	07/06/2015 Aug. 04, 2015 2015-08-11 2015-09-08
FR500	FR500M FR500E	FCC CE	OD2-FR500M KT114EC050003	May 21, 2014 05/22/2014

Product range of Fingcas

Model FM1000 is out of stock.
Please note that the product will be produced after improvement.



The End