



WIRELESS SYSTEM

CONTENTS

- Elevator Installation System
 - AP Bridge System
-

GHK-600 Series

Optical CCTV Elevator Installation System



SPECIFICATION

	GHK-600L	GHK-600M	GHK-600H
INPUT DATA			
Video Format	CVBS 2Vp-p, 75 Ohm		
TRANSMITTER			
Light Source	IR LED	IR Laser	
Wave length	630nm	658nm	
Output Power	80mW	30mW	
Diameter	50mm	50mm	
RECIEVE			
Detector	Pin Photo-Diode		AID Photo-Diode
Receive Range	~ 100m	101~150m	151~300m
Output	S-Video(CVBS), UTP		
GENERAL INFO.			
Communication	Optical Wireless Transmission		
Display	LED(Power, Signal)		
Power Consump.	200mA		
Power Voltage	DC 12V, 1A		
Operation Temp.	-20°C ~ +50°C		
Color	Black		
Dimension(mm)	100(W) x 140(H) x 100(D)		
Weight	250g/250g (Trans./Rec.)		

* Above specification is subject to change without prior notice for quality improvement.

FEATURES

- Maintenance Free & Cost-effective (NO more cabling problems)
- Real time Transmission and No Latency
- Quick and Easy Installation
- High Quality Image Transmission (DVD video quality)
- No RF interference and Intercept
- Semi-permanent lift span (Long lasting product)
- GHK-600L : Low Level B/D, Up to 100m
GHK-600M : Mid Level B/D, 100m~150m B/D
GHK-600H : High Level B/D, 150m~300m B/D

DIMENSION

(Unit : mm)



DIAGRAM

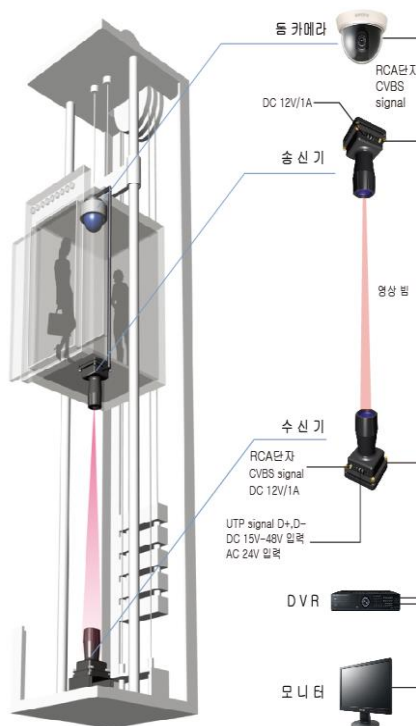

GX5-500

IEEE 802.11a/n, 5GHz Wireless AP Bridge



FEATURES

- 5.8Ghz ISM Band (802.11a/n, 150Mbps)
- Frequency Range : 5150 - 5850 MHz
- Max. Distance : 25Km(with External Antenna)
- Security Protections
; WPA, WEP, WPA-TKIP, WPA-AES, WPA2, WPA2-TKIP, WPA2-AES - MAC ACL
- Single Pole Antenna Equipped
- IP67 Rated
- Web Based Software Provided
- Install Accessory
; PoE Power Adaptor, Aluminum Bracket

ACCESSORY



DC 24V PoE



Aluminum Bracket

SPECIFICATION

GX5-500	
GENERAL INFO.	
Description	IEEE 802.11 a/n 5GHz WIRELESS LAN OUTDOOR CPE
Ethernet Port	10/100 Ethernet IEEE 802.3
Surge Protection	Built-in (IEC 61000-4-2 (ESD) and IEC 61000-4-5 (SURGE))
Wireless Speed	150Mbps
Power Source	100 - 240V AC, PoE 24V DC
Power Consumption	8W
RADIO	
Frequency Range	5150 - 5825 MHz
Modulation	BPSK, QPSK, 16QAM
Channel Bandwidth	5,10,20,40MHz
Frequency Reception	MCS0 -94 ~ MCS15 -73 dBm
Gain dBi	20dBi, Directional Beam Max. 20dBi Omni Directional Beam Max. 6dBi
Output Power	Max. 23dBi(200mW)
VSWR	≤2.0
Beam width	Horizontal : 18° / Vertical 18°
F/B Ratio	25dB
Impedance	50Ω
Input Power	100W
APPERANCE	
Operating Hum.	90%(non-condensing)
Operation Temp.	-40°C ~ +85°C
Color / Material	Ivory / Aluminum
Dimension(mm)	270(W) x 270(H) x 70(D)
Weight	2.5Kg

* Above specification is subject to change without prior notice for quality improvement.

BRACKET ADJUSTMENT



1. Left/Right : 90°
2. Left/Right : 360°
3. Upward Horizontal : 180°
Downward : 45°

GX5-500

IEEE 802.11a/n, 5GHz Wireless AP Bridge

Diagram for Tx. : Installation for Analog Camera

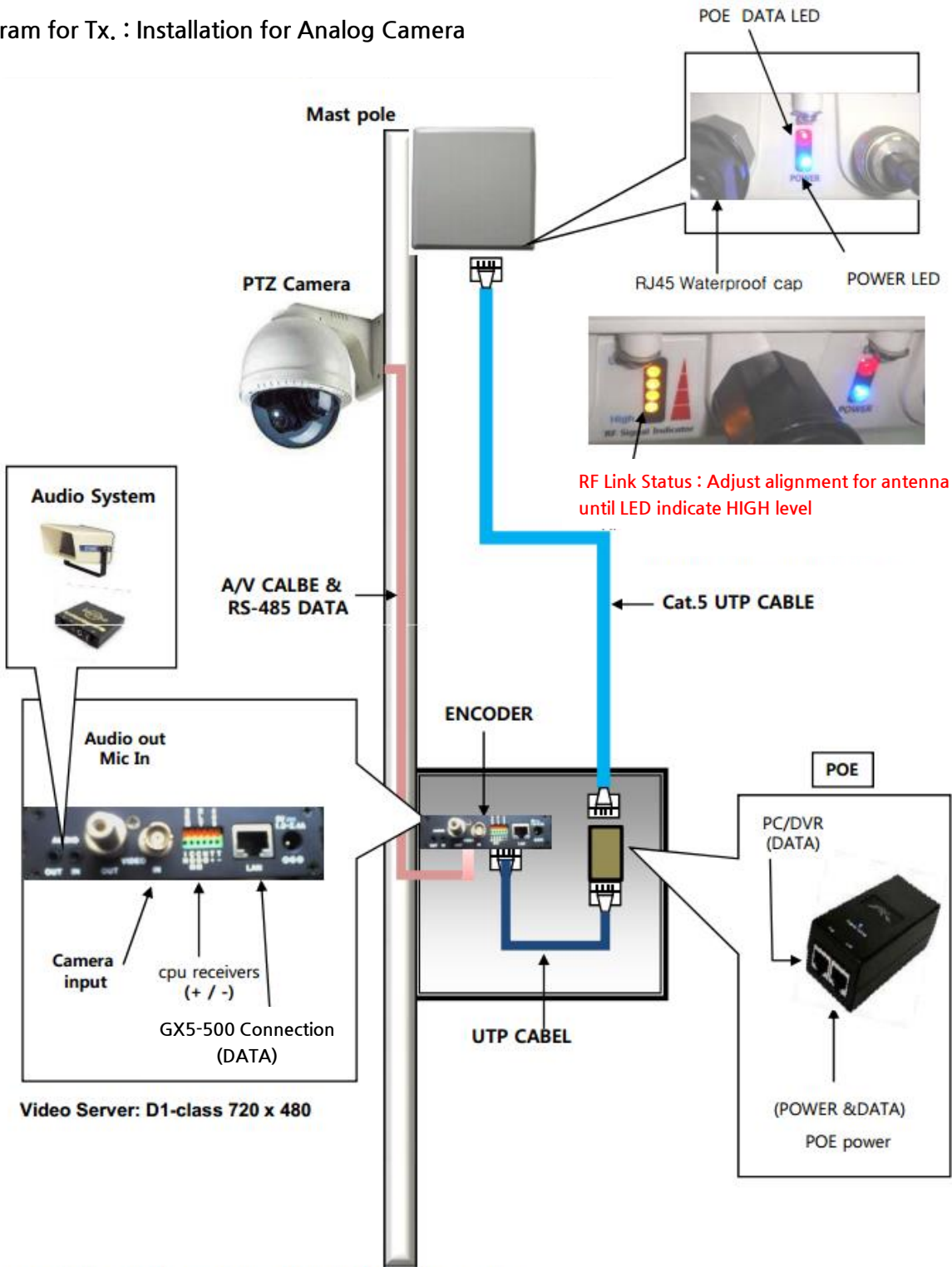

PTZ cameras and video servers transmit the configuration

NETWORK

HD-SDI

ANALOG

WIRELESS

SENSOR

INDSUTRIAL

GX5-500

IEEE 802.11a/n, 5GHz Wireless AP Bridge

Diagram for Rx. : Installation for Analog DVR

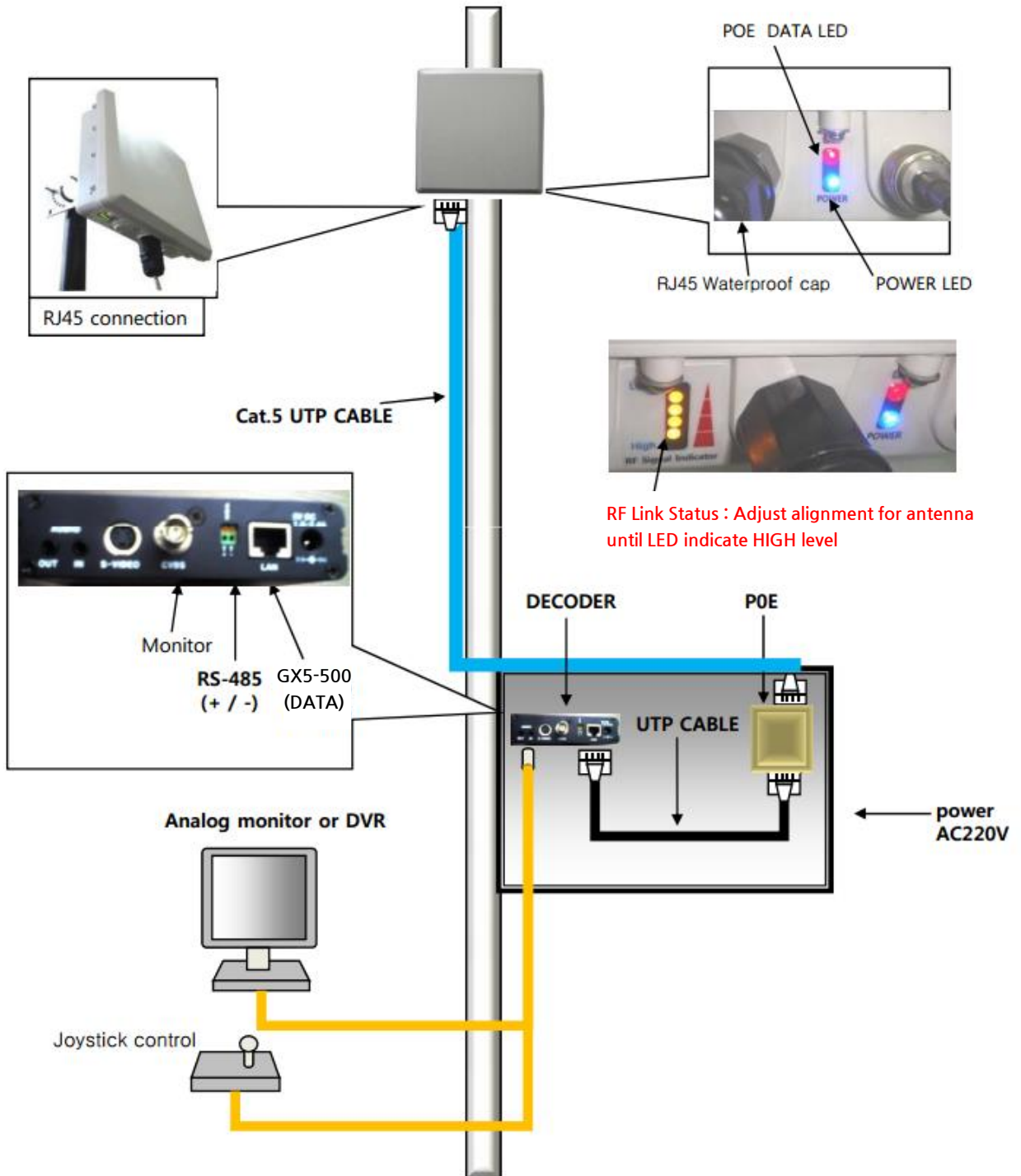

DECODER video receiver configuration with

NETWORK

HD-SDI

ANALOG

WIRELESS

SENSOR

INDUSTRIAL

GX5-500



2014

IEEE 802.11a/n, 5GHz Wireless AP Bridge

Diagram for Tx. : Installation for Megapixel IP Camera

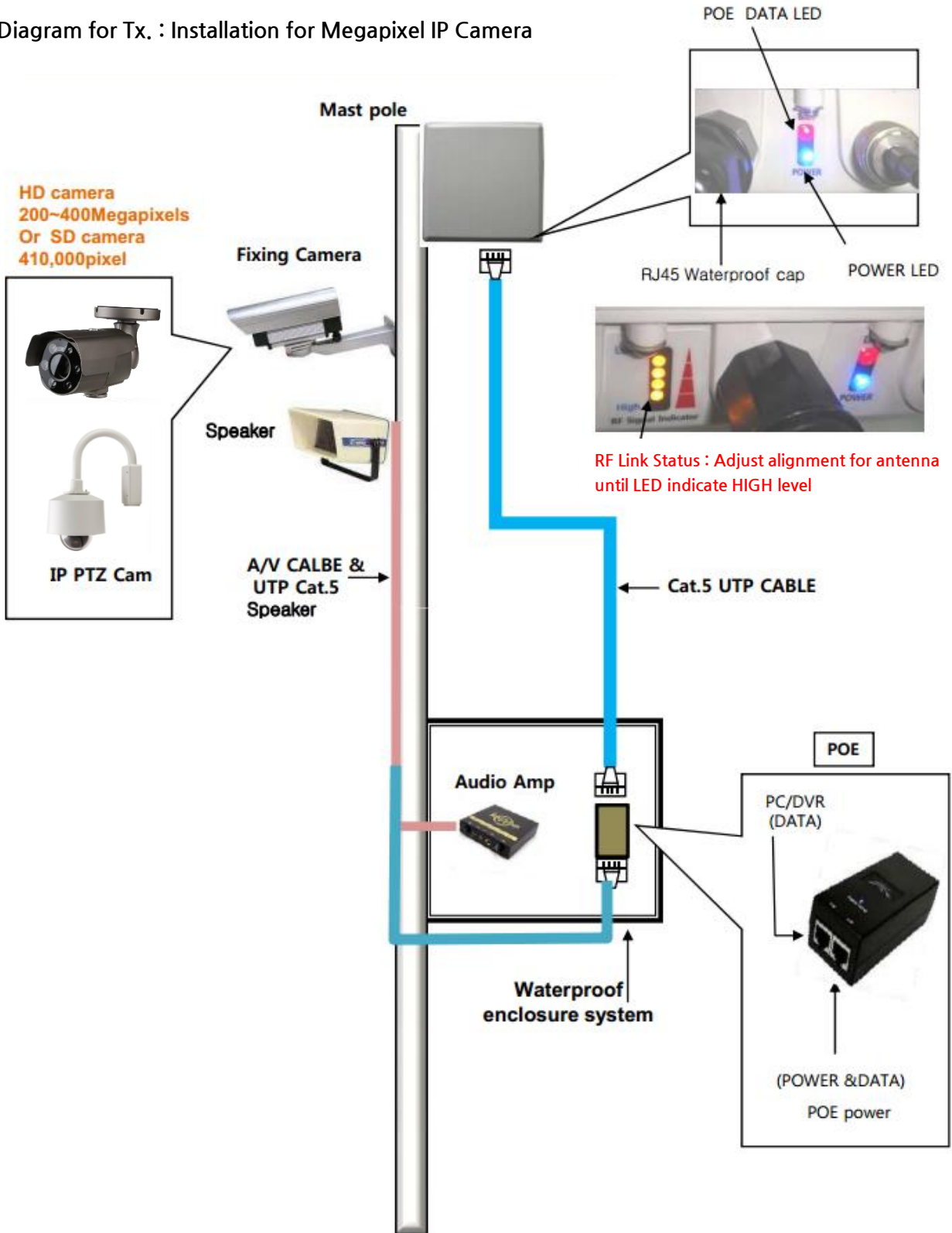

NETWORK

HD-SDI

ANALOG

WIRELESS

SENSOR

INDUSTRIAL

GX5-500



2014

IEEE 802.11a/n, 5GHz Wireless AP Bridge

Diagram for Rx. : Installation for NVR at the Center

