

# REAL<sup>®</sup>

SINCE 1972

**REAL CHOICE OF THE BEST LOCK**

**Reliable  
Endurable  
Accurate  
Lock**

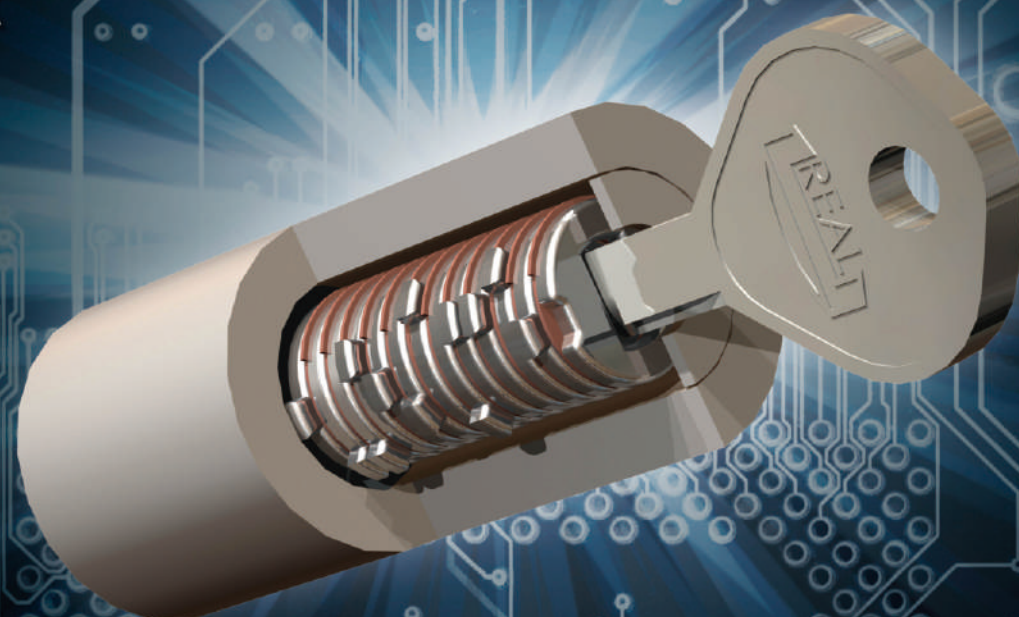

**REAL LOCKS & SECURITY CO., LTD.**

Address : 3F, No.61, Wuchiuan Rd., New Taipei Industrial Park, New Taipei City 24886, Taiwan.

Tel : 886-2-2299-2200 Fax : 886-2-2299-2792 / 2299-2793

e-mail : [info@reallock.com](mailto:info@reallock.com) / [beatrice@reallock.com](mailto:beatrice@reallock.com) [www.reallock.com](http://www.reallock.com)



## REAL KEYLESS / COMBINATION LOCK

ITEM NO.	RL-9041	RL-9043	RL-9046	RL-9047	RL-10347	RL-9961	RL-8051
PHOTO							
Suitable for Door thickness	0.04"~0.9" (1~23mm)	0.024"~0.078" (0.6~2mm)	0.04"~1.3" (1~33mm)	0.04"~1.14" (1~29mm)	0.04"~1.14" (1~29mm)	0.04"~1.3" (1~33mm)	0.04"~0.78" (1~20mm)
Mechanism System	Dual system Personal Identify No. & override key	Dual system Personal Identify No. & override key	Dual system Personal Identify No. & override key	Combination lock W / Detecting shim	Dual system Personal Identify No. & override key	Identify Card, Tag with Temporary power supply	Compatible with any kinds of Padlock
Available door direction	Vertical: Right-hinge-open / Left-hinge-open Horizontal: Right-hinge-open	Vertical: Right-hinge-open	Vertical: Right-hinge-open / Left-hinge-open	Vertical: Right-hinge-open / Left-hinge-open Horizontal: Right-hinge-open / Left-hinge-open	Vertical: Right-hinge-open / Left-hinge-open	Vertical: Right-hinge-open	Vertical: Right-hinge-open / Left-hinge-open
Type	Cam	Cam	Cam	Cam	Cam	Bolt	Cam
Mounting Hole	 91.5 x 33mm	 16 x 19mm	 91 x 33mm	 16 x 19mm	 16 x 19mm	 16 x 19mm	 16 x 19mm
Lock body / Finish	Zinc Alloy / Black Nickel Plated	Zinc Alloy / Platinum Plated	Zinc Alloy Platinum Plated or Champagne Plated	Zinc Alloy / ED Coating Black	Zinc Alloy / ED Coating Black	ABS / Coating Black	Zinc Alloy / Chrome or Brass Plated



## Keyless Combination Lock

### RL-9041

#### Features

- Material: Metal
- Lock Opening Direction: Vertical : Right/ Left Opening  
Horizontal : Right Opening
- Color: Black Nickel
- RL-9041 was designed for multi-facilities of private lockers & public lockers, not only providing high security and convenience for users, but also providing its sustainability and durability under high use.
- Solid metal materials supports long term heavy use and very convenient for short term use.
- High Quality Assurance - 10,000 possible combinations with high security keyway.
- Easily setting up users' own personal codes at any time, with high security override key for emergency opening only.
- Easy installation for multi-lockers, available for wooden, metal, and phenolic lockers. Fitting locker door thickness between 0.04"~0.90" (1~23mm).
- 10,000 combinations; high security and patented key profile, can't copy anywhere.
- The duplicated key is for specific managers only.
- Detecting the users' pre-set codes by manager only, user still can use his original numbers.
- The next users can reset a new combination codes again.
- Excellent outer shape design matches with fashion lockers.
- Sales Volume: Over 250,000 pcs in the world.
- Good customer reference: Over 300 customers in the world, including gyms, fitness centers, hotels, schools, worker lockers, spas, medical lockers and so on.
- Patented in Taiwan, China.



Vertical Type



Horizontal Type

unit: mm / inch

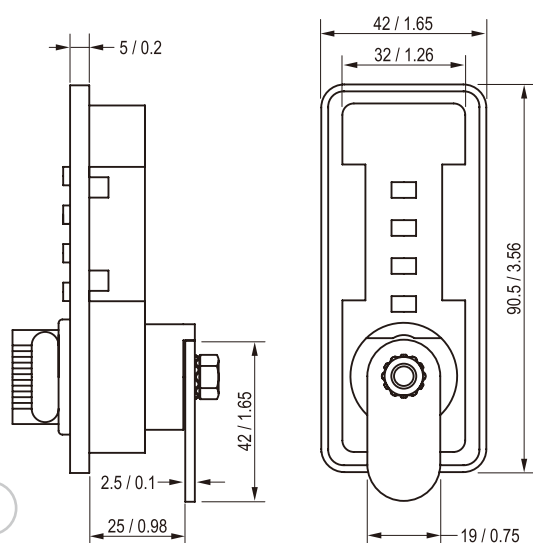

### RL-9046

- Material: Metal
- Cylinder: Brass (REAL detained disc cylinder).
- Finish: Platinum / Champagne color.
- No card, no wire, no battery, and no key locking system.
- Dual mechanism: digits combination and override key for emergency opening.
- Fit door thickness: between 0.04"~1.3" (1~33mm)
- User can set up to 10,000 combinations.
- Suitable for lockers in gym, fitness center, school, hospital, worker room, safe box, mail box, etc.
- Patent in : USA (US7,367,207B2), Germany ,China ,Taiwan.
- Customer Reference: Carrefour, YMCA, Mattel Health & Fitness Center, Fitness First, Flex Resorts & Real Estate, Crown Plaza Hotel, WCC College, Pennsylvania University, etc.

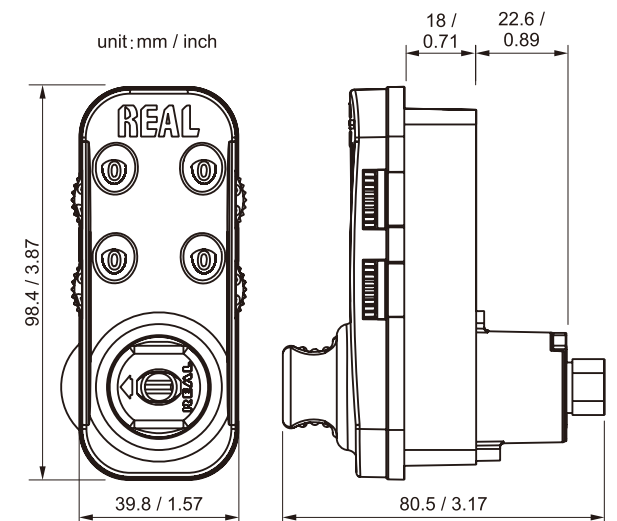



## Keyless Combination Lock

### RL-10347

- Material: Zinc alloy lock panel.
- Dual Mechanism : With override key for emergency opening.
- Rotate one circle to set new numbers.
- Door thickness : 0.04"~1.14" (1~29mm)
- Different colors are available.
- Suitable for locker, cabinet, tooling box, mail box or any storage box.
- User can set up their own number: 10,000 combination
- No handle or pull required, built-in knob to open and close locker.
- Anti-peeping
- Fitting for the existing hole of cam lock(diameter:16mm /19mm), easy for installation and replacement for standard cam lock.

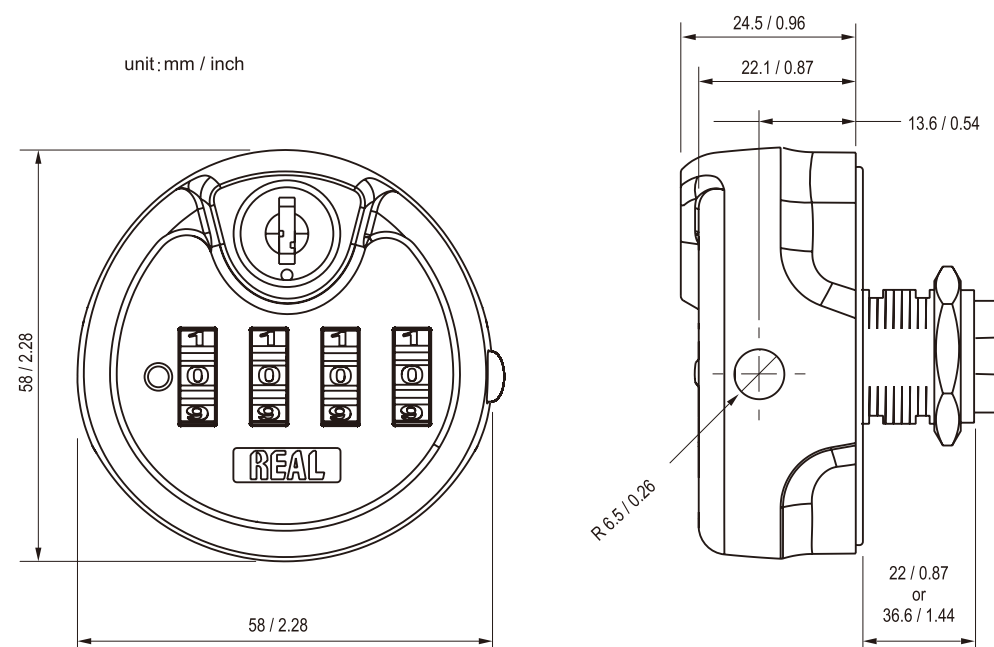

## CABINET LOCK

### RL-9047

- Material : zinc alloy lock housing.
- Fitting for the existing hole of cam lock (diameter : 16mm/19mm), easy for installation.
- Users can set up their own numbers:1,000 combinations.
- Recoding button allows for resetting combinations much easier.
- No handle or pull required, built-in knob to open / close door.
- Decoding shim is available for management to find the forgotten codes.
- Different colors are available.
- Door thickness : 0.04"~1.14" (1~29mm)
- Different cams are available.
- Suitable for safe box, locker, cabinet, mail box, tooling box or any storage box.

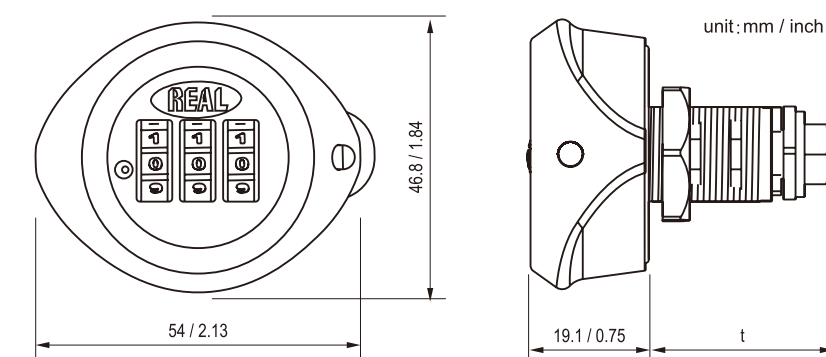



## NFC Lock

### RL-9961

- Lock :NFC Technologies (Type 2 Tag Reading/ Card Emulation)
- Tag: NFC Type 2 with NDEF Encryption Records. (ISO14443A)
- Runs for standard 1.5V AA batteries.
- Door thickness:0.04"~1.3" (1~33mm)
- Independent power system provides the highest degree of the operation safety.
- Temporary power supply unit helps the managers to open the locker when the lock is out of power.
- LED light reminds the locker status including the low power and incorrect operation.
- Changeable front panel provides a cost-effective solution for lock owner.
- Wake up function for saving the power.
- Wide range of application for leisure, hotels, fitness centers, clinics and schools, etc.
- Stand alone and whole system(ODM service) are available.

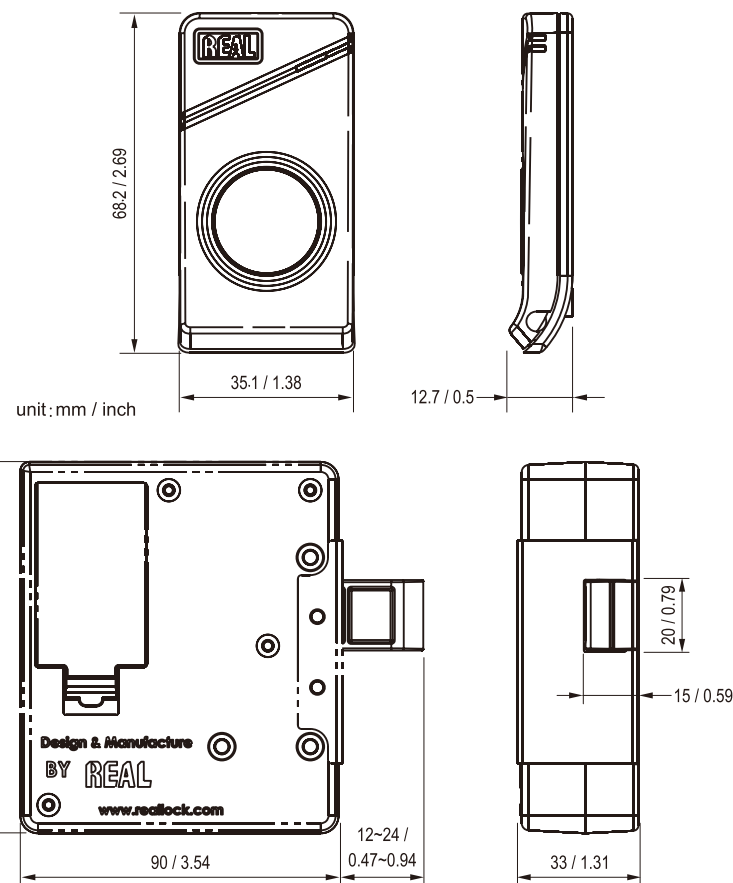

## Keyless Combination Lock

### RL-9043

- Material : zinc alloy lock housing.
- No wire, no battery, no card, no keys and no headache of management.
- Suitable for 0.024"~0.078" (0.6~2mm) thickness of locker door.
- Users can set up their own numbers: 1,000 combinations.
- Override key for emergency opening.
- Knob can be used for opening, setting and closing.
- Any users can set new numbers at any time.
- Rotate one circle to set new numbers.

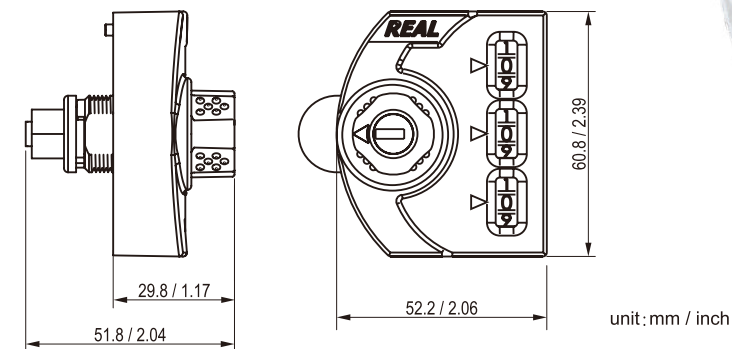

### RL-8051

- Material : zinc alloy
- Finish : Chrome-plated / brass-plated available.
- The lock barrel is permanently locked in place with screws.
- Can be used with any kinds of padlocks.
- Used for lockers, cabinets, storage boxes and similar equipments.

