

F10



BREAKOUT AND REBOOT AI FACE RECOGNITION MACHINE



FEATURES

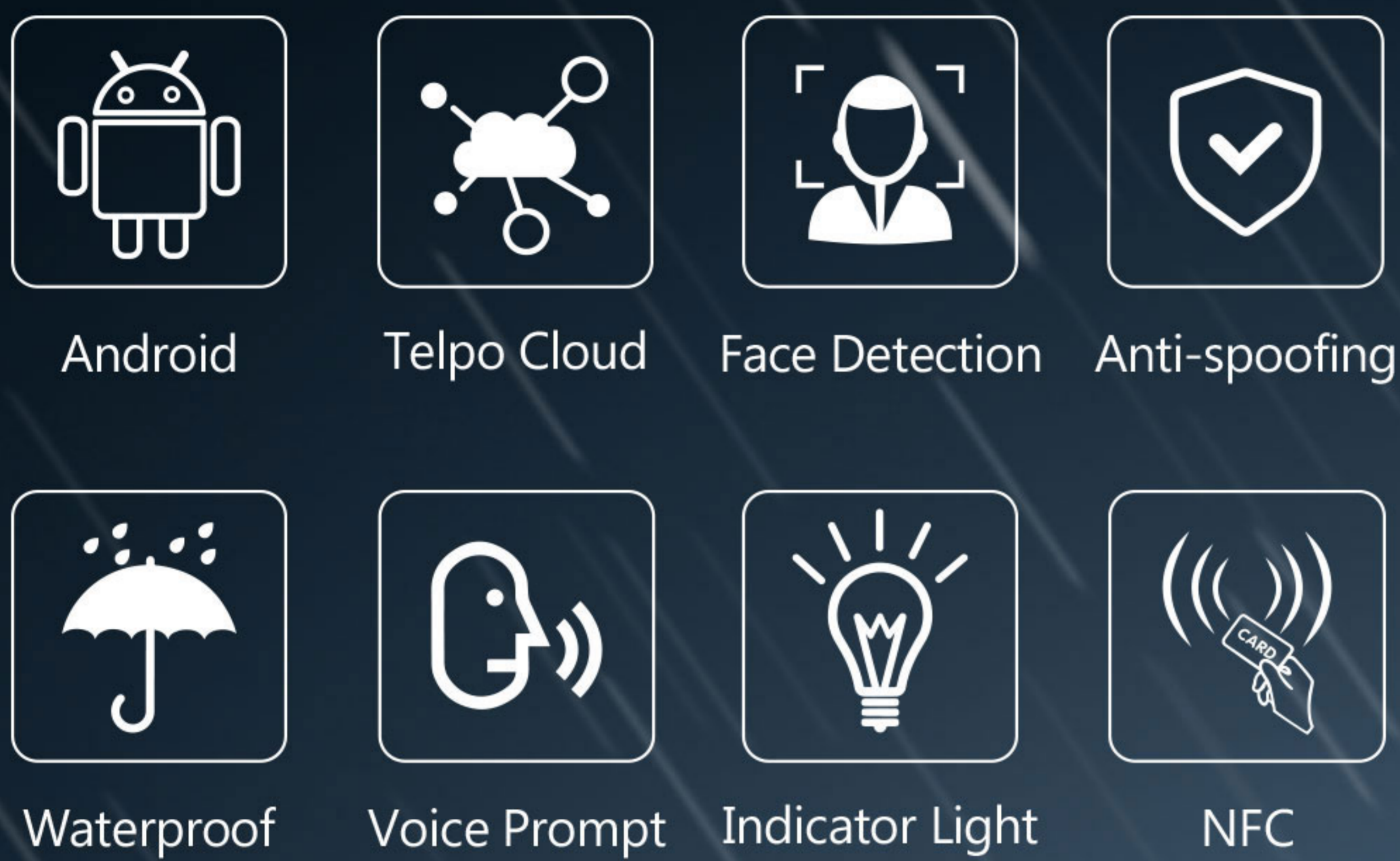

FUNCTIONS



F10 AI FACE RECOGNITION MACHINE

Specification	
OS	Android 9.0 or above
Processor	Octa-Core 1.8GHz
Memory	2GB DDR, 16GB eMMC 4GB DDR, 64GB eMMC (Optional)
Display	10-inch, 800*1280
Keys	1 Reset Key
Sensor	Infrared Sensor(Optional)
Front Camera	Dual-lens Camera (RGB+IR), 2MP+1.3MP Single-lens Camera (RGB), 2MP (Optional) 3D Depth Sensing Camera (Optional)
Fill Light	White LED
Status Indicator Light	Red/Green/Blue
Contactless Card Reader	ISO14443 Type A/B, ISO18092 compliant HID Cards (Optional)
Communications	Ethernet/WiFi/Bluetooth
Temperature Measurement (Optional)	Distance : 50 ~ 70cm Accuracy : ± 0.3 °C
Peripheral Ports	1 DC Port, 1 RJ45, 1 micro USB, 1 Wiegand Input, 1 Wiegand Output, 1 RS485, 1 RS232, 1 Relay, 1 USB TypeA
Audio	Digital Audio Speaker, Microphone
Power Supply	12V/2A
Bracket (Optional)	Wall Mount Bracket, Turnstile Mount Bracket
MDM (Optional)	Mobile Device Management
Certification	CE, FCC, RoHS, TELEC, IP66

Note: Reserve the right to change the parameters without prior notice.

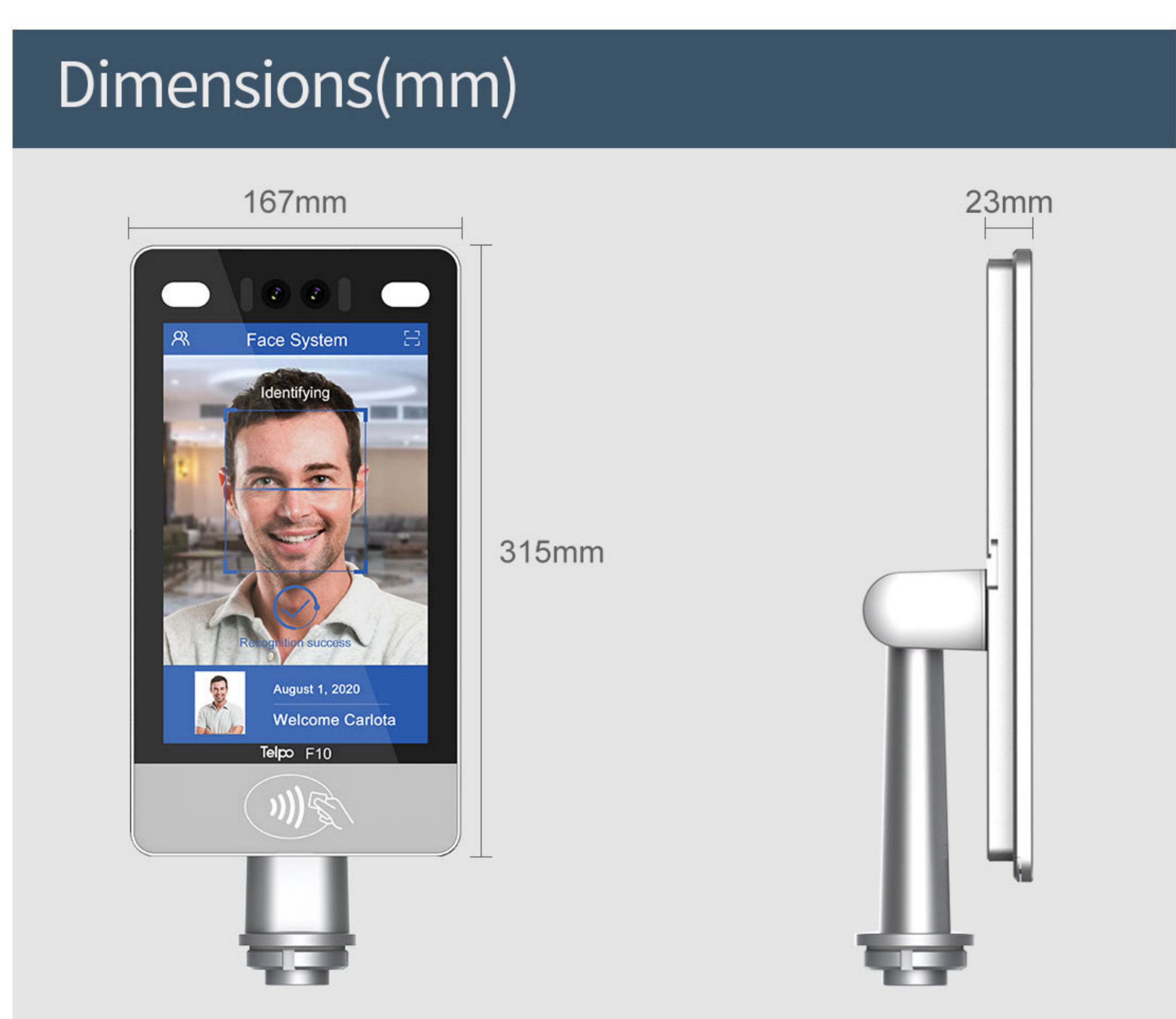
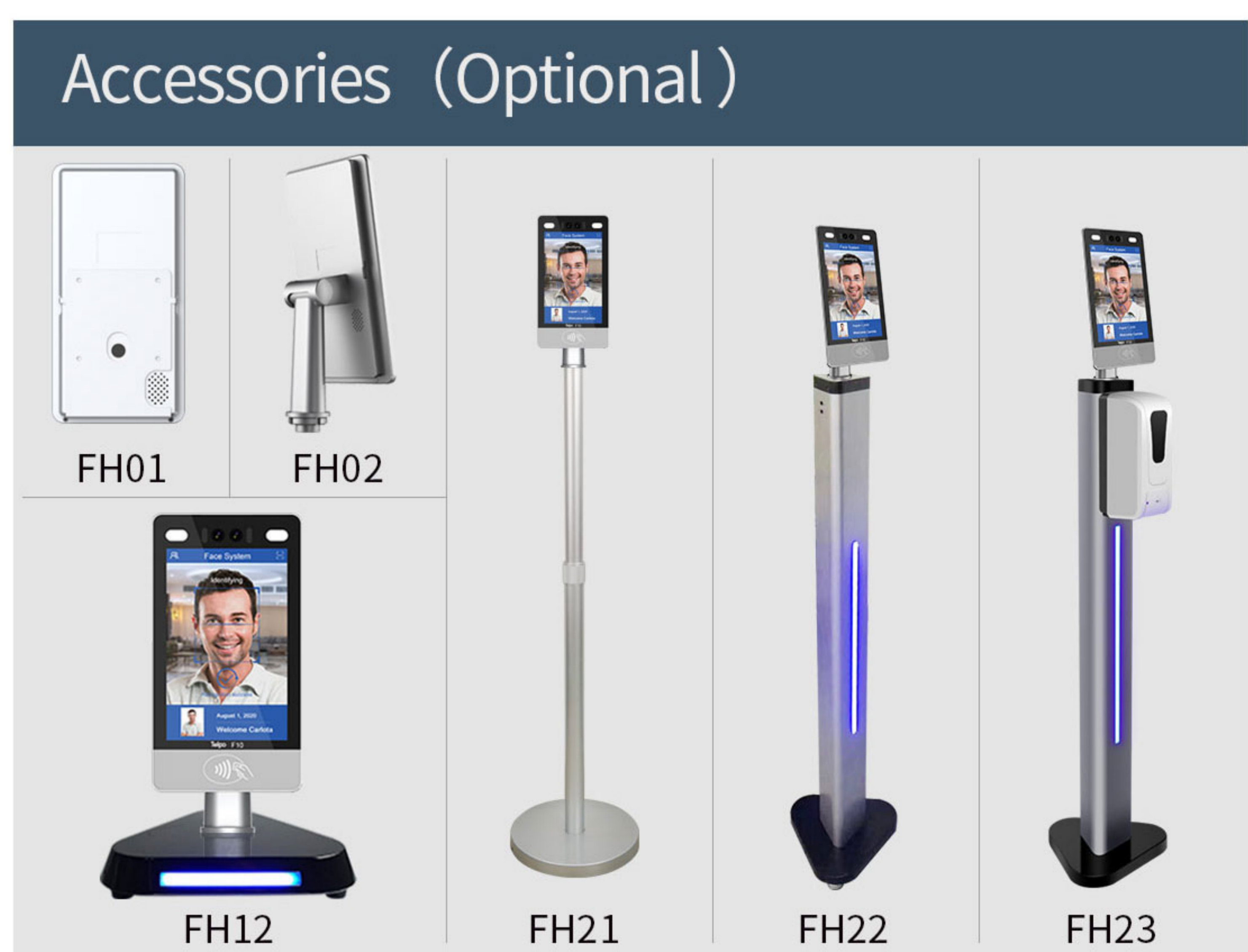

Telepower Communication Co.,Ltd.
 E-mail: business@telpo.com Skype: [telpo_business](https://www.skype.com/name/telpo_business)
 Web: www.telpo.com.cn
 Add: Foshan City, Guangdong Province, China

