

Mini Dome Camera

Features

- * SONY high quality CCD with high definition
- * S/N Ratio: > 48dB, Auto Electronic Shutter: up to 1/100,000 sec.
- * Auto AGC/WB/BLC & AES switchable
- * Lens: 3.6mm (standard) & 6,8,12mm lens (optional)
- * Special for multi-light or dark surroundings, such as: hotel, toll station and prison etc.
- * Detail and clear monitoring pictures with naturally soft colors under little light
- * Convenient for lens selection, different focal length and different type of lens can be selected, such as auto iris lens, manual zoom lens and IR sensing function lens.



Technical Data

Model No.	APG-DC200-01C	APG-DC200-02C
CCD Type	SONY 1/3" CCD	
Horizontal Resolution	420TVL	480TVL
Effective Pixel	PAL:512H×582V / NTSC:512H×492V	PAL:752H×582V / NTSC:768H×494V
TV System	PAL/NTSC	
Minimum Illumination	0.8Lux/F1.2	0.8Lux/F1.2
Angle	/	/
S/N Ratio	≥48dB	
Video Output	1.0Vp-p/75Ω	
AGC	AGC ON /OFF (switchable)	
White Balance	Auto tracking	
Back Light Compensation	BLC ON/OFF switchable	
Exposure Control	EE (Electronic Exposure) / AI (Auto Iris Lens) switchable	
Electronic Shutter	NTSC:1/60 to 1/100,000 sec.(ON/OFF) PAL:1/50 to 1/100,000 sec.	
Gamma Correction	0.45	
Sync System	Internal Synchronization	
Lens	3.6mm (standard) , 2.8mm/4mm/6mm/8mm/12mm (optional)	
Power Requirements	DC12V±5%	
Operation Temperature	-20°C~+50°C	

Extreme High Resolution Mini Dome Camera

Features:

- * Special three-axis gear: horizontal rotation 355°, vertical rotation 90°
- * Convenient mount and free adjustment monitoring point, which solves dead angle problem of mini dome
- * Sony CCD and DSP (Digital Signal Processing)
- * High quality image, real color, high resolution with AGC and AWB function
- * Special designed optical housing to reduce light loss



Technical Data

Model No.	APG-DC200-03C	APG-DC200-03A
CCD Type	1/3" SONY Super-HAD CCD	
Horizontal Resolution	540TVL	
Effective Pixel	PAL:752H×582V / NTSC:768H×494V	
TV System	PAL/NTSC	
Minimum Illumination	0.8LUX/F1.2	
S/N Ratio	≥48dB	
Video Output	1.0Vp-p/75Ω	
AGC	AGC ON /OFF (switchable)	
White Balance	Auto tracking	
Back Light Compensation	BLC ON/OFF switchable	
Exposure Control	EE (Electronic Exposure) /AI (Auto Iris Lens) switchable	
Electronic Shutter	NTSC:1/60 to 1/100,000 sec.(ON/OFF) PAL:1/50 to 1/100,000 sec.	
Gamma Correction	0.45	
Sync System	Internal Synchronization	
Lens	4mm	4~9mm (Auto Iris Lens)
Power Requirements	DC12V±5%	
Operation Temperature	-20°C~+50°C	

Extreme High Resolution Mini Dome Camera

Features:

- * Special three-axis gear: horizontal rotation 355°, vertical rotation 90°
- * Convenient mount and free adjustment monitoring point, which solves dead angle problem of mini dome
- * Sony CCD and DSP (Digital Signal Processing)
- * High quality image, real color, high resolution with AGC and AWB function
- * Special designed optical housing to reduce light loss
- * 128X WDR



Technical Data

Model No.	APG-DC200-03W
CCD Type	1/3" SONY Super-HAD CCD
Horizontal Resolution	Color:580TVLINE, B/W:600TVLINE
Effective Pixel	PAL:752H×582V / NTSC:768H×494V
TV System	PAL/NTSC
Minimum Illumination	0.1LUX/F1.2
S/N Ratio	≥48dB
Video Output	1.0Vp-p/75Ω
AGC	AGC ON /OFF (switchable)
White Balance	Auto tracking
Back Light Compensation	BLC ON/OFF switchable
Exposure Control	EE (Electronic Exposure) /AI (Auto Iris Lens) switchable
Electronic Shutter	NTSC:1/60 to 1/100,000 sec.(ON/OFF) PAL:1/50 to 1/100,000 sec.
Gamma Correction	0.45
Sync System	Internal Synchronization
Lens	3.5~8mm
Power Requirements	DC12V±5%
Operation Temperature	-20℃~+50℃

Mini Dome Camera

Features

- * SONY high quality CCD with high definition
- * S/N Ratio: > 48dB, Auto Electronic Shutter: up to 1/100,000 sec.
- * Auto AGC/WB/BLC & AES switchable
- * Lens: 3.6mm (standard) & 6,8,12mm lens (optional)
- * Special for multi-light or dark surroundings, such as: hotel,toll station and prison etc.
- * Detail and clear monitoring pictures with naturally soft colors under little light
- * Convenient for lens selection, different focal length and different type of lens can be selected, such as auto iris lens, manual zoom lens and IR sensing function lens.



Technical Data

Model No.	APG-DC200-01VP	APG-DC200-02VP	APG-DC200-03VP
CCD Type	1/3" SONY Super-HAD CCD		
Horizontal Resolution	420TVL	480TVL	540TVL
Effective Pixel	PAL:512H×582V / NTSC:512H×492V	PAL:752H×582V / NTSC:768H×494V	
TV System	PAL/NTSC		
Minimum Illumination	0.1LUX/F1.2		
Angle	60°		
S/N Ratio	> 52dB		
Video Output	1.0Vp-p,75Ω		
AGC	AGC ON / OFF (switchable)		
White Balance	Auto		
Back Light Compensation	Auto		
Exposure Control	EE (Electronic Exposure) / AI (Auto Iris Lens) switchable		
Electronic Shutter	NTSC:1/60 to 1/100,000 sec.(ON/OFF) PAL:1/50 to 1/100,000 sec.		
Gamma Correction	0.45		
Sync System	Internal Synchronization		
Lens	3.6mm Lens		
Power Requirements	DC12V ±10%		
Operation Temperature	-20°C~+50°C		

Mini Dome Camera (Flying Disk Style)

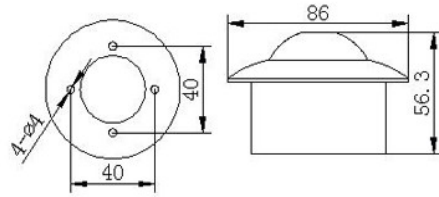

Features

- * High quality Sony CCD with DSP function
- * High quality image and real color with high resolution, auto gain control, auto white balance
- * Metal shell, professional optical material to reduce light losing in the maximum extent
- * Easy Installation, convenient adjust
- * Reliable performance, stable quality, reasonable price to be widely used in bank, hotel, mall, office building, hospital, school, government.

Technical Data

Model No.	APG-DC200-01U	APG-DC200-02U	APG-DC200-03U
CCD Type	SONY1/3"Super HAD CCD		
Horizontal Pixel	PAL:512(H)×582(V) / NTSC:510(H)×492(V)	PAL:752(H)×582(V) / NTSC:768(H)×492(V)	
System	PAL/NTSC		
Horizontal Resolution	420TVLine	480TVLine	540TVLine
Minimum Illumination	0.1Lux		
S/N Ratio	» 48db		
Video Output	1.0Vp-p/75Ω		
AGC	Auto		
AWB	Auto		
Back Light Compensation	Auto		
Exposure Control	EE (Electronic Exposure)		
Electronic Shutter	1/50(1/60) to 1/100000sec.		
Gamma Correction	0.45		
Sync System	Internal Synchronization		
Lens	3.6mm (Standard)		
Power Requirements	DC12V±5%		
Operation Temperature	-20°C—50°C		
Weight	0.23kg		