



# Wireless Smart Home System



## Home Gateway

- Home Automation
- Burgler-Proof
- Anti-Disaster
- Emergency alert

## Security



### Motion Sensor

- Pet-Immune function
- Efficient power consumption
- Low battery alert function



### Contact Sensor

- Low battery alert function
- Efficient power consumption

## Control



### Button Console

- Multi-Functional  
Arm / Disarm / Emergency
- Efficient power consumption
- Support automation application



### Panel Console

- Monitor and control system status
- Power backup



### Power Meter Switch

- Home Automation
- Switch Link: Linked with other sensors
- Equipped with a router function
- Monitor power consumption for energy saving



### Siren Switch

- Loud sound 90db
- Low battery alert function
- Efficient power consumption

## Safety



### Smoke Sensor

- Photoelectric optical detection
- Built-in Buzzer
- Low battery alert function



### CO2 Sensor

- Temperature & Humidity monitoring
- NDIR technology
- Built-in Buzzer

## Signal



### Analog Input Transducer

- Monitor the 3rd party industrial detector status
- Switch Link: Linked with other sensors
- Efficient power consumption



### Digital Input Transducer

- Monitor the 3rd party industrial detector status
- Switch Link: Linked with other sensors
- Efficient power consumption



### Lock Switch

- Monitor and open the door remotely
- Control the 3rd party electronic lock



Wireless

# Smart Home System



## APP Management

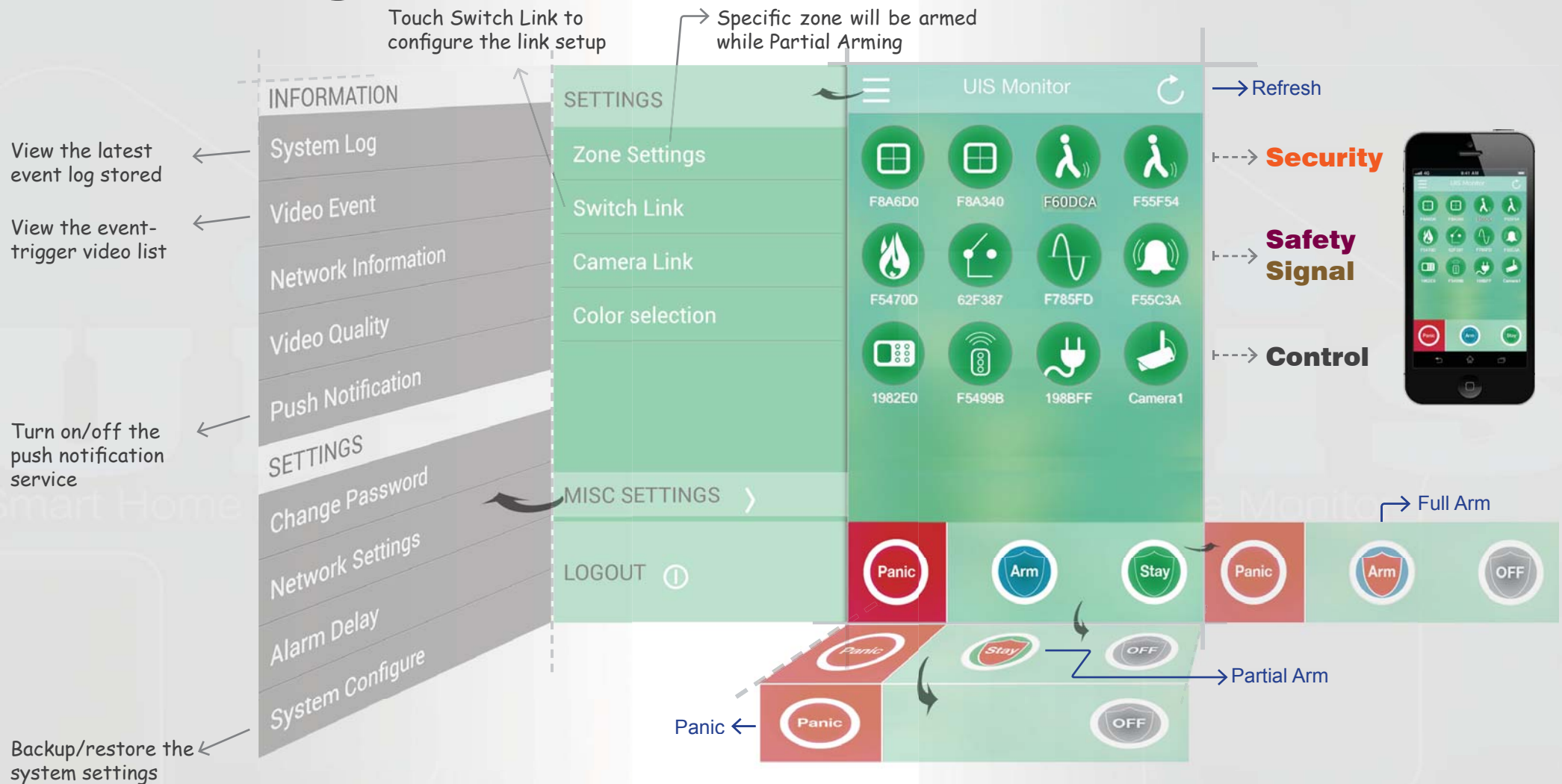



## System Topology



### Wireless Sensor Network (WSN)

ZigBee Pro Mesh Network  
 Gateway ↔ Router: 300m (LOS)  
 Router ↔ Router: 300m (LOS)  
 Sensor ↔ Gateway/Router: 50m (LOS)

- Max connections: 100
- Router cascade-able: 3 levels
- Easy install: Touch-n-Play



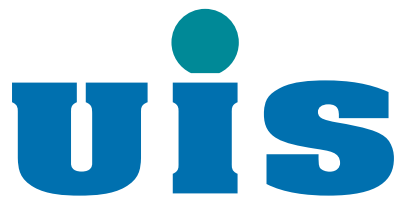

Wireless

# Smart Home System



## Highlight Feature



Enable WiFi / Tab APP icon



Login / Start system setup



Reboot

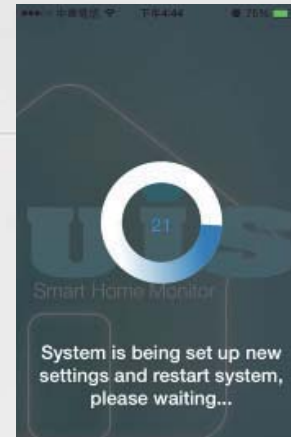

Start device setup



Power on devices



Reboot



Main Page

